

TOP VIEW

scale 1:10

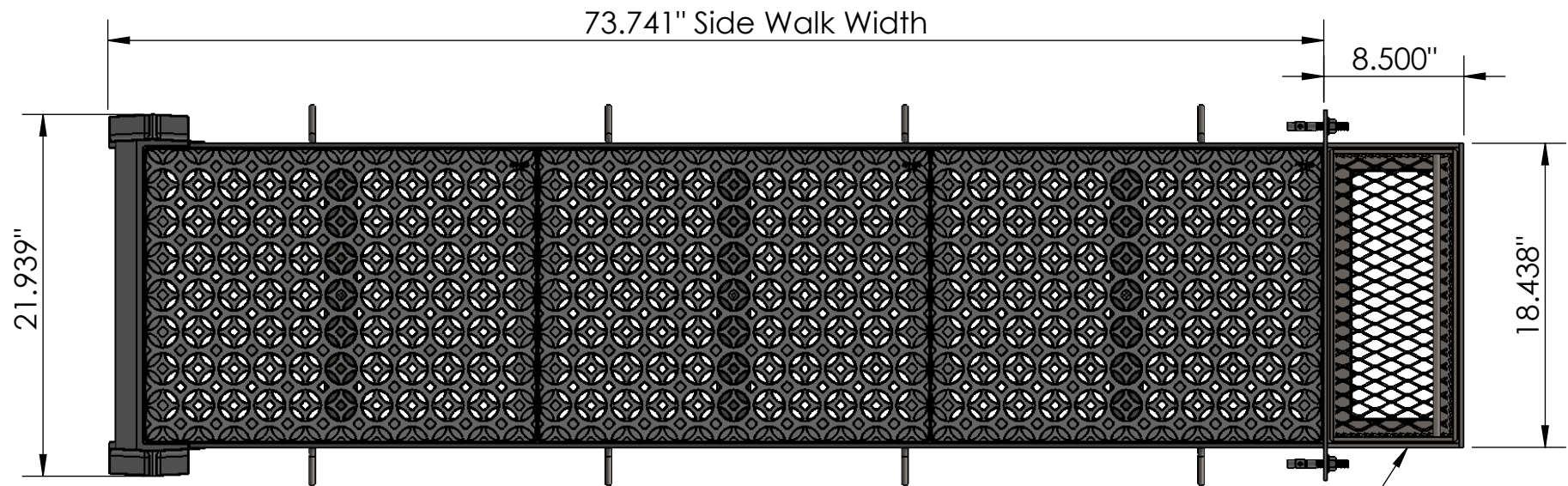

SIDE VIEW

scale 1:10

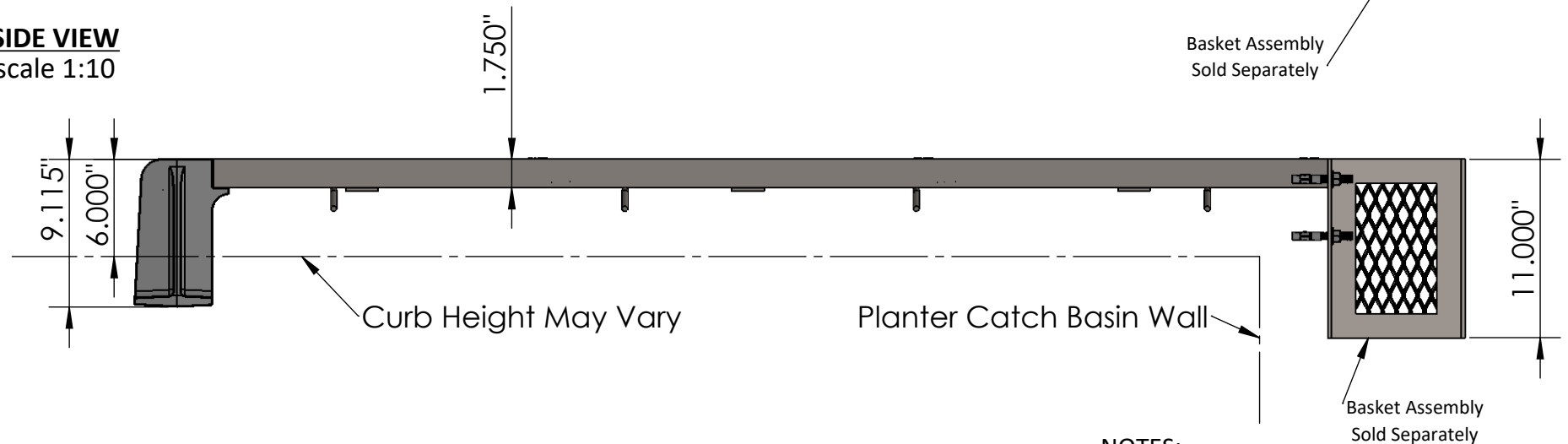

NOTES:

1. Ships as 1 Unit.
2. Due to casting inconsistencies, all dimensions are nominal.

Made in USA

©2019 Iron Age Designs

18" Curb Inlet with Basket Assembly (Sold Separately)

IRON AGE
DESIGNS
Telephone 206.276.0925
www.ironagegrates.com

Material: Cast Ductile Iron Castings/ Mild Steel
Standard Finish: Raw / Powder Coat
Fits: Iron Age Custom Frame

Weight: approx. 300 lbs.
Edge Thickness: 1.50"
Product ID: N/A

Free Area (approx): XX.XX"sq (XX.X%)
Gallon/ Min (approx): sq area x FDA x1.31= GPM

Drawing Name: 18"Curb Inlet with 3 grates and Basket

By: MS Date: 10/31/19
Scale: NTS

© Registration: Pending

Page 1

ISO-VIEW
scale 1:10

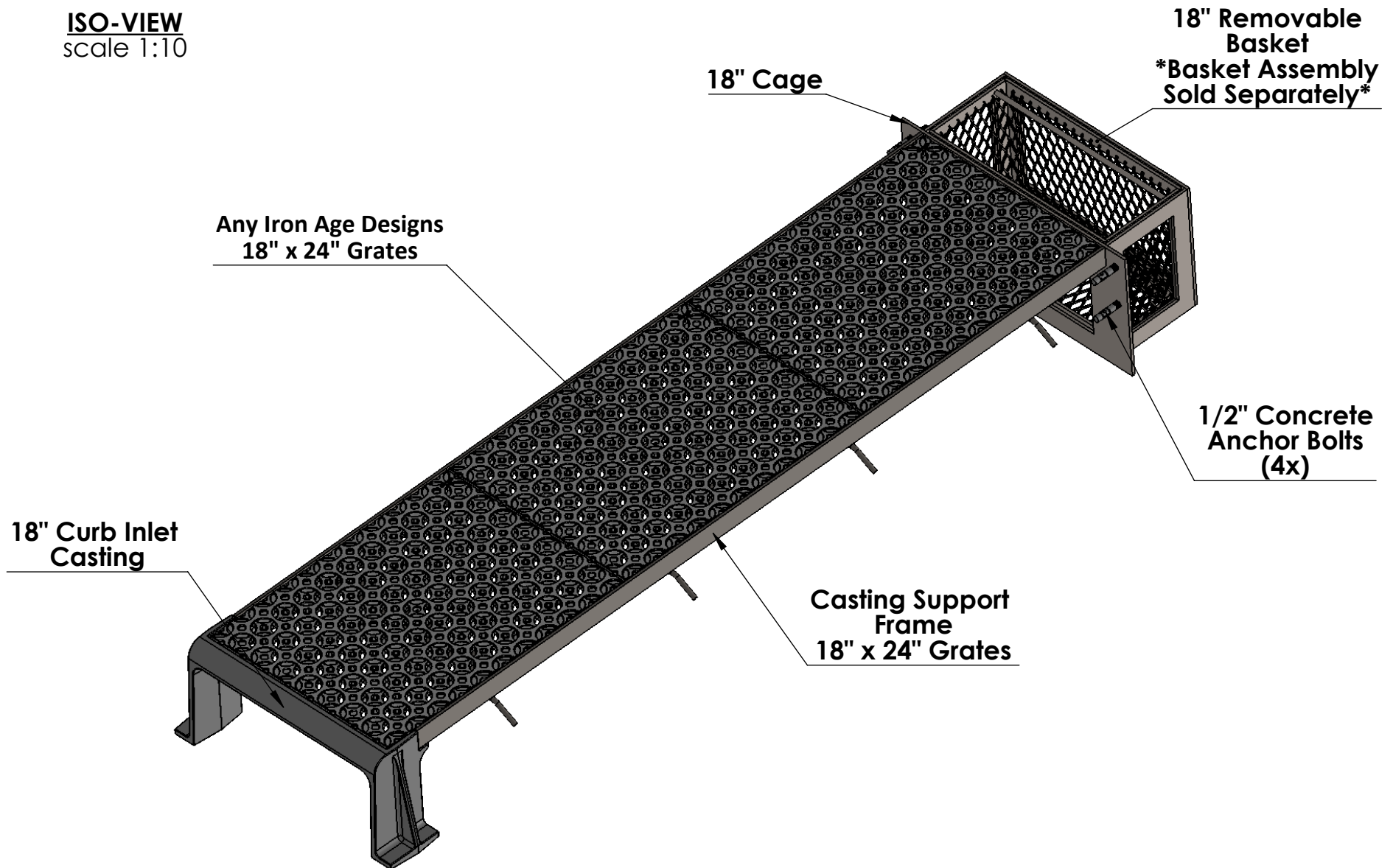

NOTES:

1. Ships as 1 Unit.
3. Due to casting inconsistencies, all dimensions are nominal.

Made in USA

©2019 Iron Age Designs

18" Curb Inlet with Basket Assembly (Sold Separately)

**IRON AGE
DESIGNS**
Telephone 206.276.0925
www.ironagegrates.com

Material: Cast Ductile Iron Castings/Mild Steel
Standard Finish: Stainless Steel
Raw / Powder Coat
Fits: Iron Age Custom Frame

Weight: approx. 300 lbs.
Edge Thickness: 1.500"
Product ID: N/A

Free Area (approx): XX.XX"sq (XX.X%)
Gallon/ Min (approx): sq area x FDA x1.31= GPM
Drawing Name: 18"Curb Inlet with 3 Castings and Basket

By: MS Date: 10/31/19
Scale: NTS

© Registration: Pending

Page 2

BASKET REMOVED

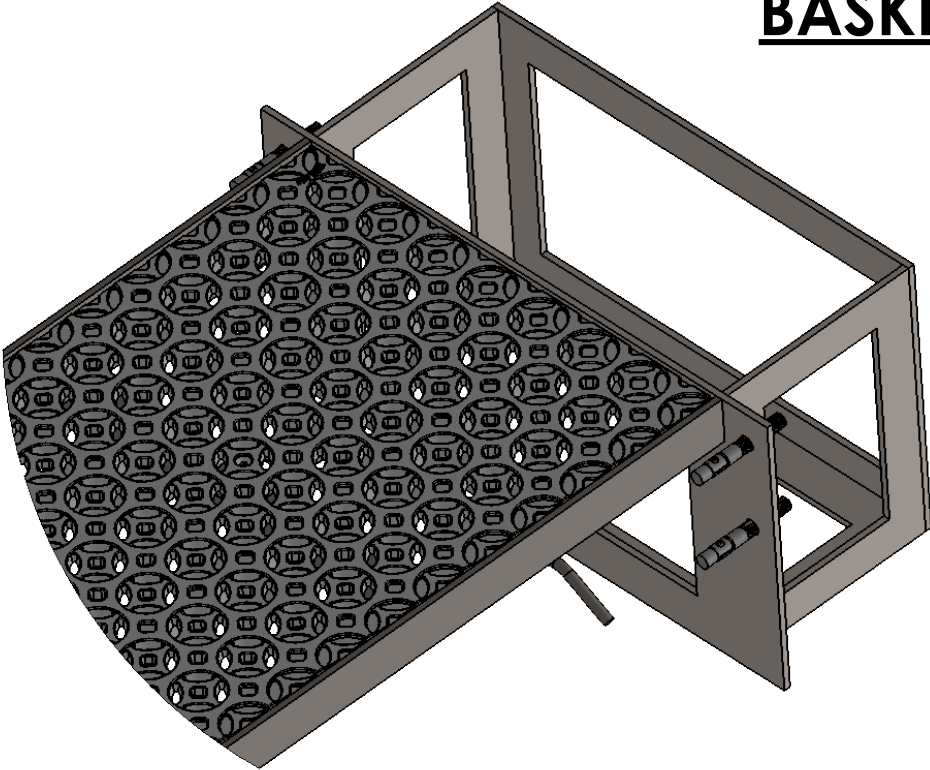

NOTES:

- 2. Ships as 1 Unit.
- 3. Due to casting inconsistencies, all dimensions are nominal.

Made in USA ©2019 Iron Age Designs

18" Curb Inlet - Basket Removed

TOP VIEW
scale 1:5

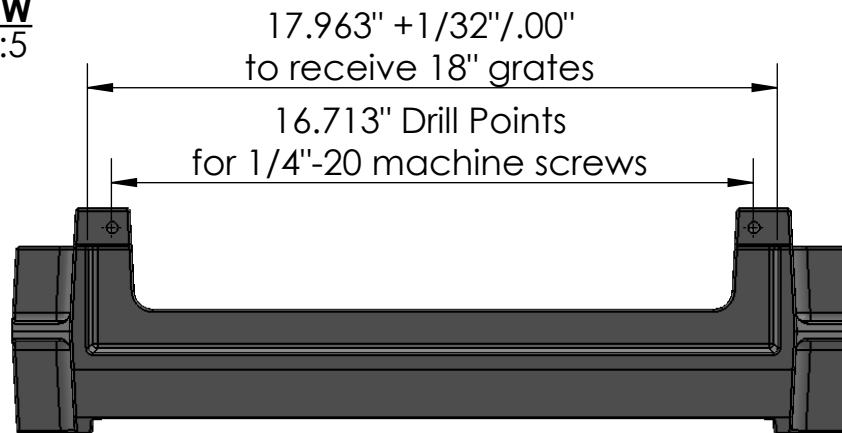

END-VIEW
scale 1:5

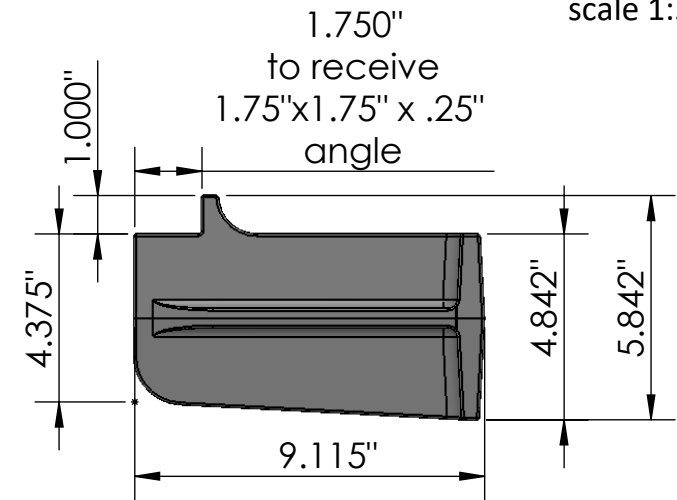

SIDE VIEW
scale 1:5

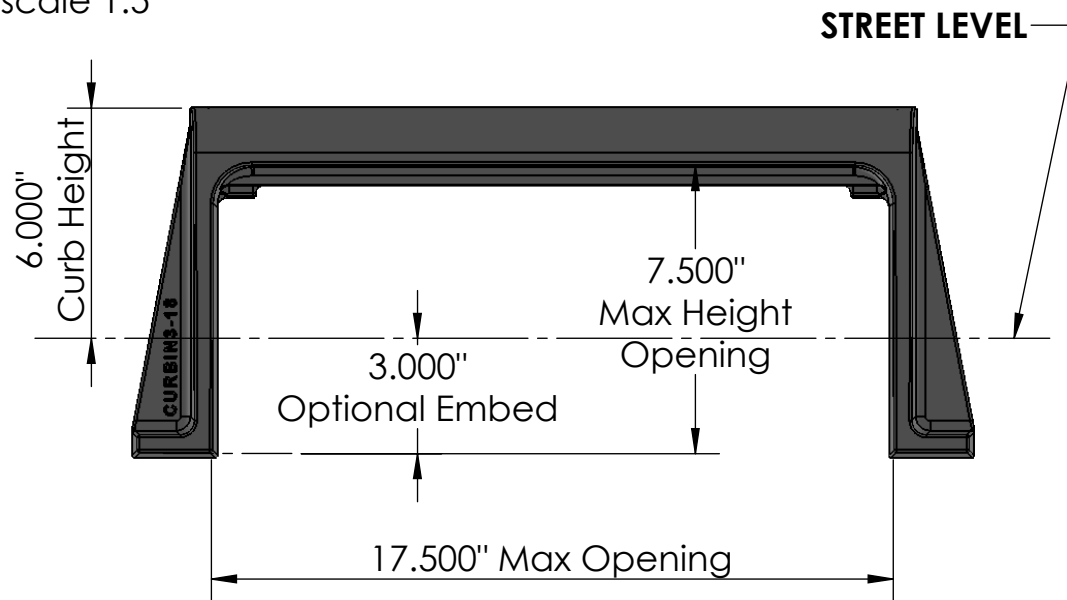

ISO-VIEW
scale 1:5

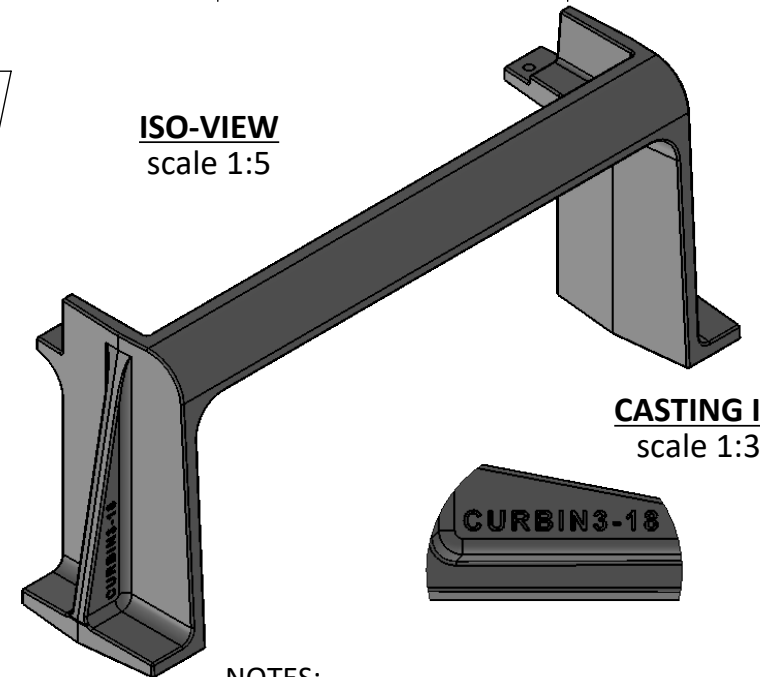

CASTING ID
scale 1:3

NOTES:

1. Ships in 1 piece.
2. Due to casting inconsistencies, all dimensions are nominal.

Made in USA ©2019 Iron Age Designs

18" Curb Inlet Casting

TOP VIEW
scale 1:12

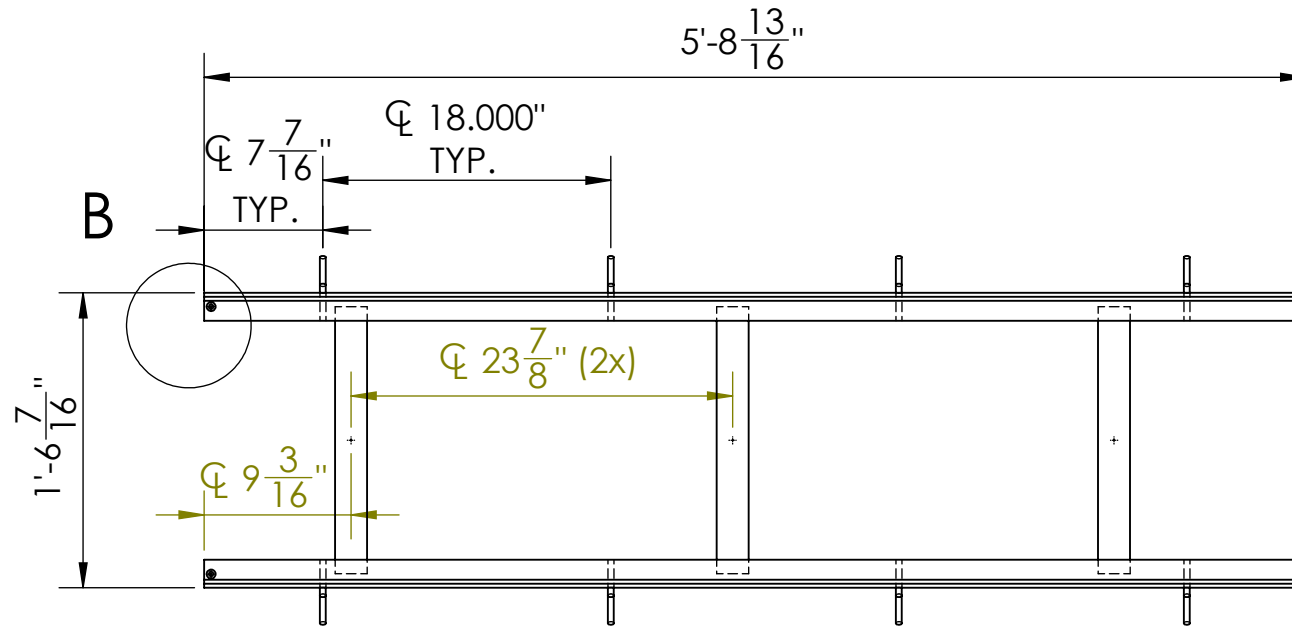

1.75" x 1.75" x .25"
Angle (2x)

2" x .25" Flat Bar
Cross Support (3x)

#3 Rebar / 3/8" Round
(8x)

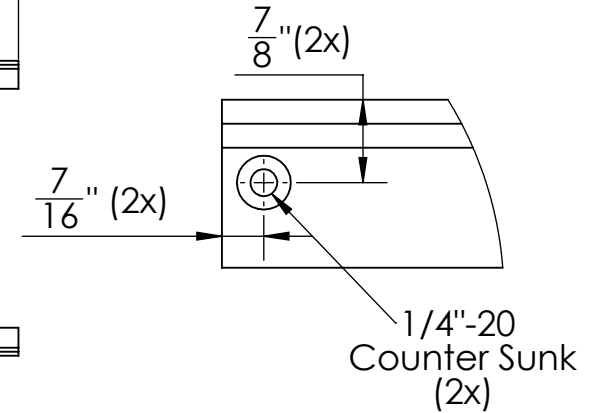

DETAIL B

SCALE 1 : 2

SIDE VIEW
scale 1:12

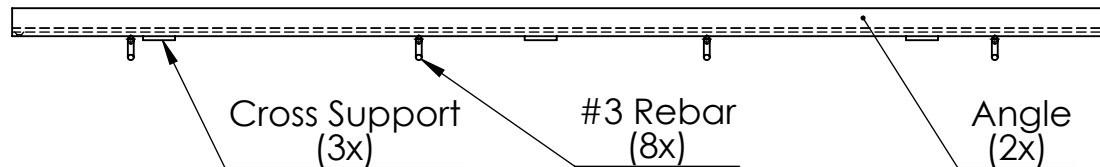

NOTES:

1. Heelproof: No thru openings greater than 1/4"
2. Ships in 1 piece.
3. Due to casting inconsistencies, all dimensions are nominal.

Made in USA

©2019 Iron Age Designs

18" Curb Inlet - Custom "E" Frame

18" x 24" Interlaken

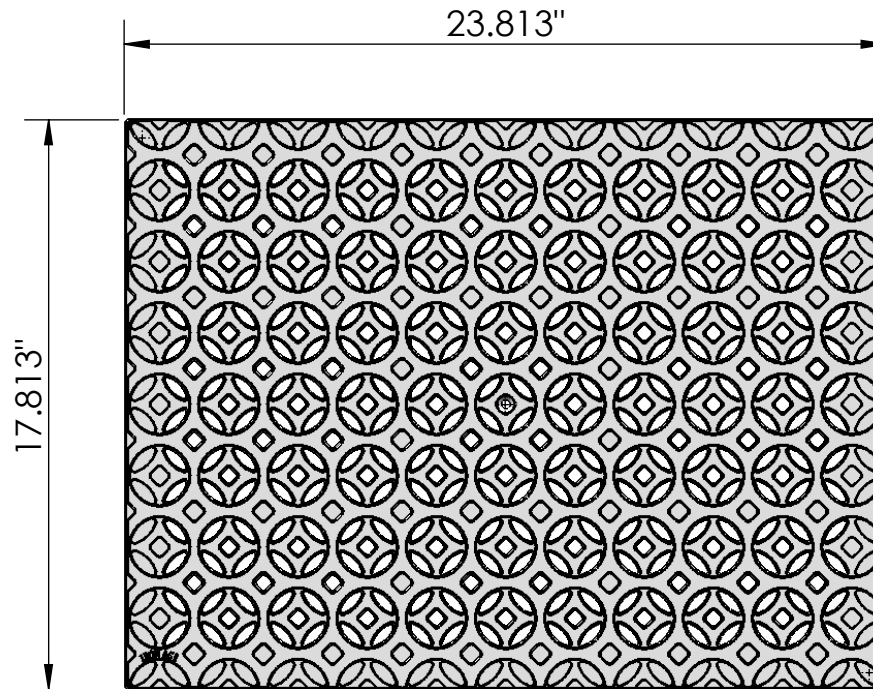

NOTES:

1. ADA Compliant: No Thru Holes bigger than $\frac{1}{2}$.
2. Ships in multiple pieces.
3. Due to casting inconsistencies, all dimensions are nominal.

Made in USA ©2019 Iron Age Designs

18" Curb Inlet - 18x24 Interlaken Trench Grate

SIDE VIEW

scale 1:6

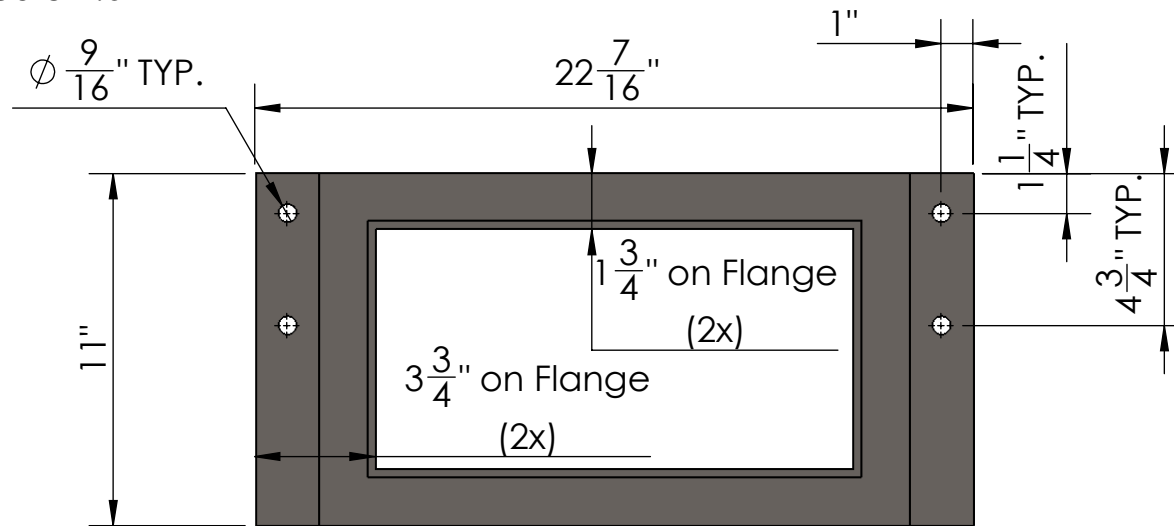

Bottom Plate Welded
Flush with Flange

TOP VIEW

scale 1:6

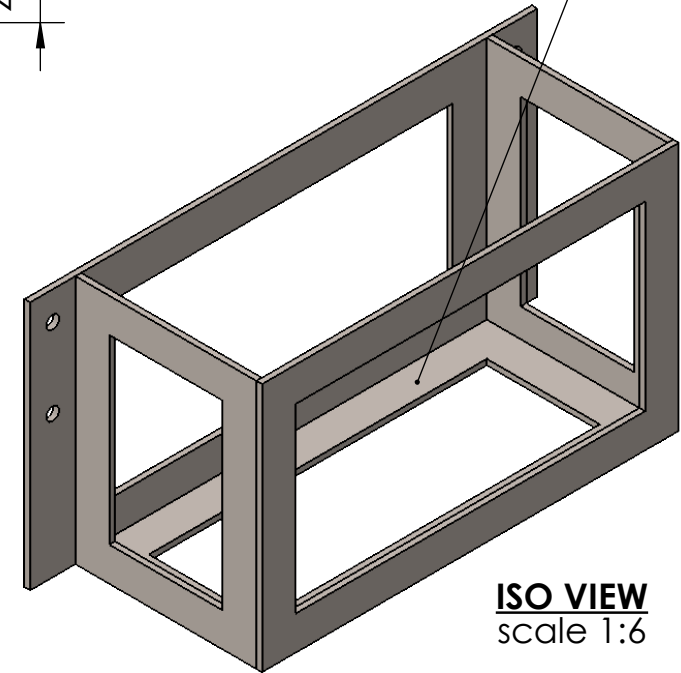
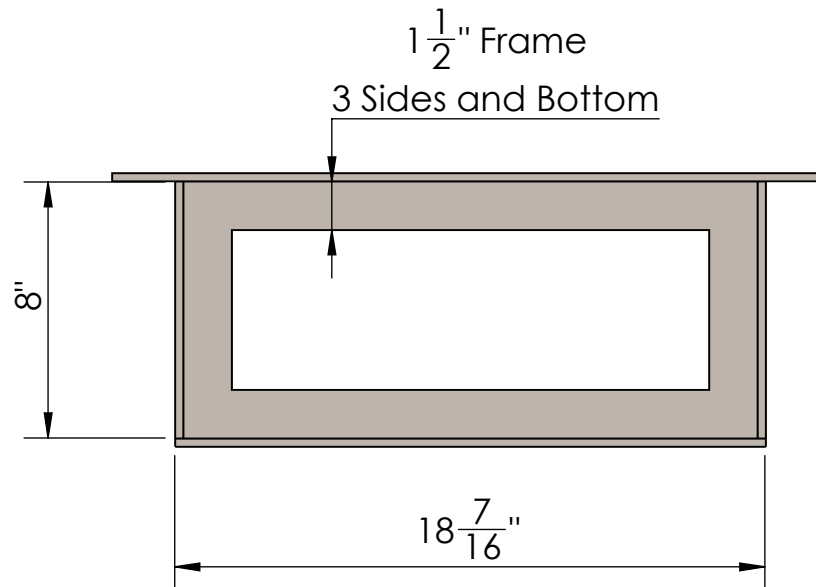

ISO VIEW
scale 1:6

NOTES:

1. All Sheet Metal $\frac{1}{4}$ " Stainless Steel
2. All Welds Must be Clean
3. Ships in 1 piece.
4. Due to Fab inconsistencies, all dimensions are nominal.

Made in USA

©2019 Iron Age Designs

18" Curb Inlet - Cage

TOP VIEW
scale 1:6

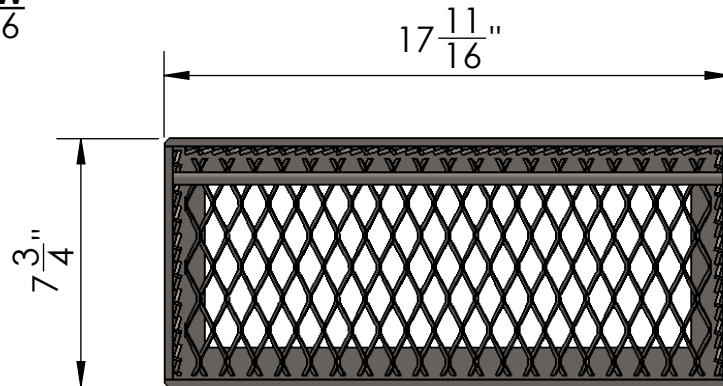

1" TYP. Opening
3 Sids & Bottom

END VIEW
scale 1:6

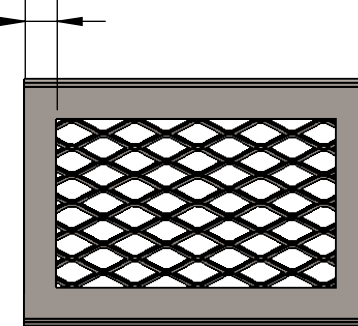

3/8" Round Bar
Handle
Welded in Approx.
Area

OPEN SIDE VIEW
scale 1:6

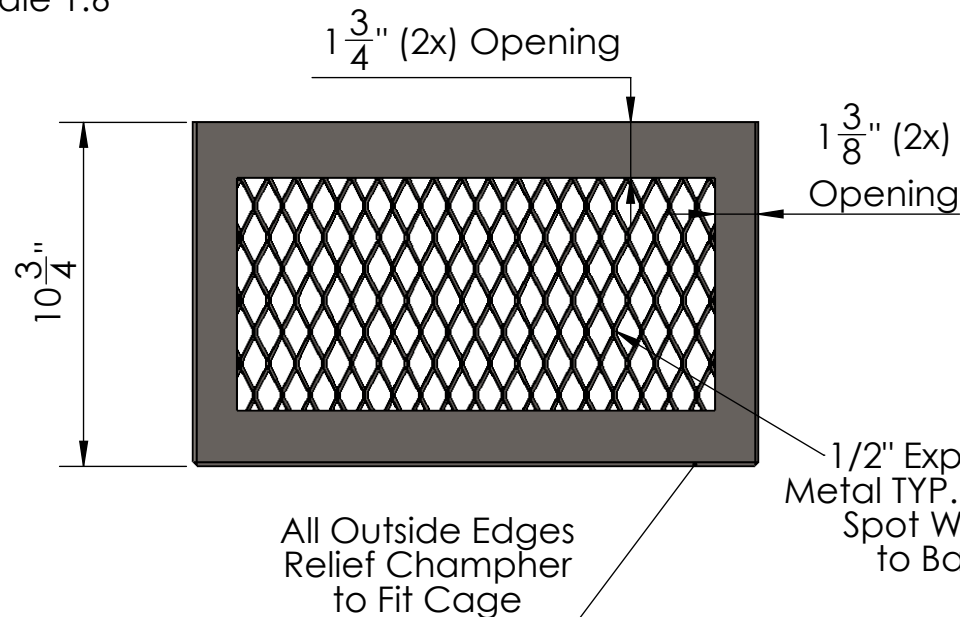

ISO-VIEW
scale 1:6

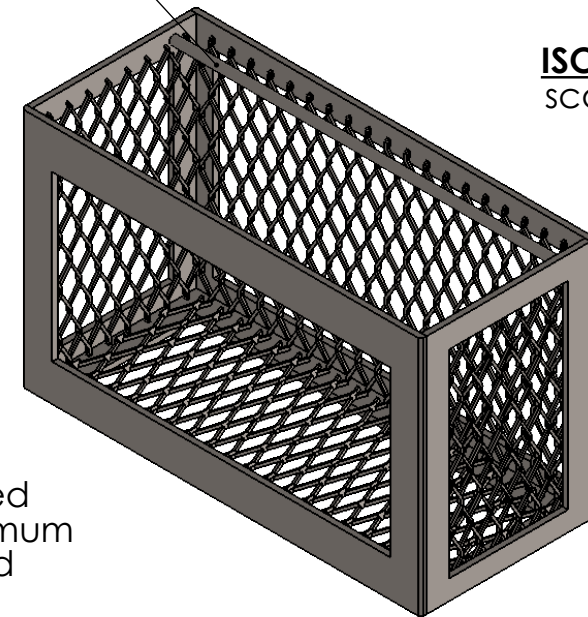

NOTES:

1. All Sheet Metal Thickness 1/4"
2. Ships in 1 piece.
3. Due to Fabrication inconsistencies, all dimensions are nominal.

Made in USA

©2019 Iron Age Designs

18" Curb Inlet - Basket

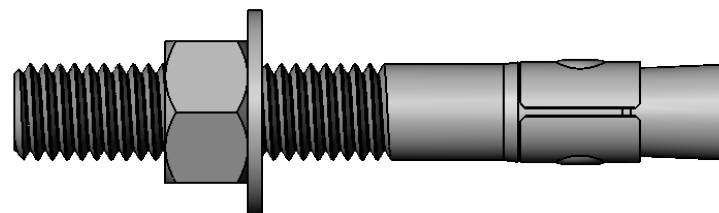
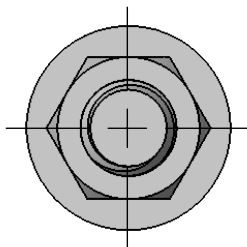

QTY. 4
1/2"-13 x 2.5"
Concrete Anchor

NOTES:

1. Ships in 4 piece.

Made in USA

©2019 Iron Age Designs

18" Curb Inlet - Cage - Concrete Anchor