

3 ARRAY
scale 1:7

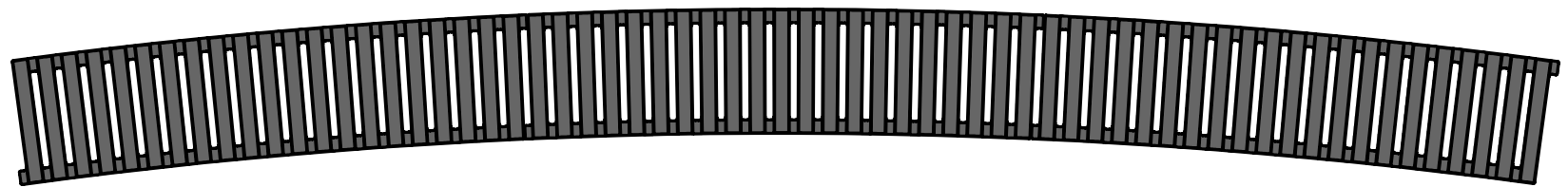

TOP VIEW
scale 1:4

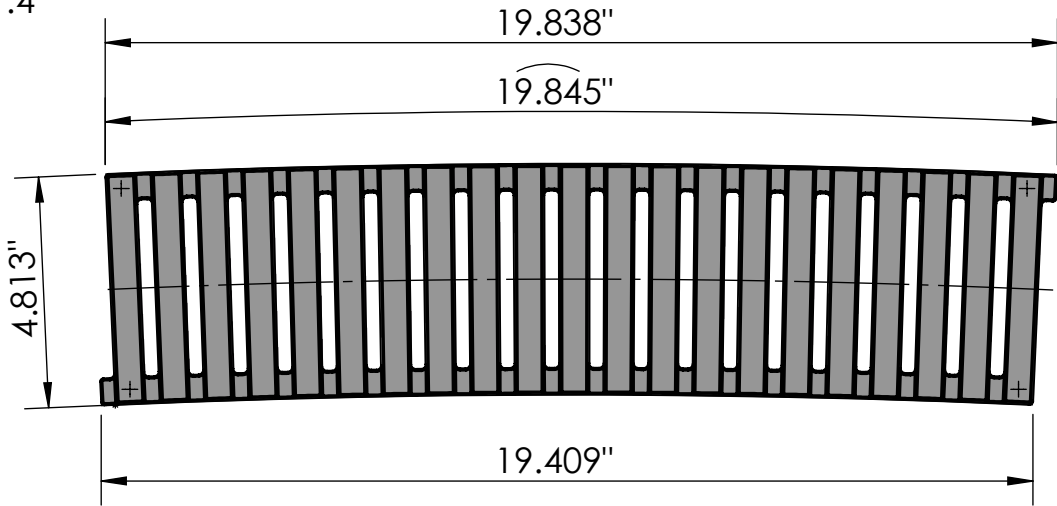

CASTING-ID
scale 1:2

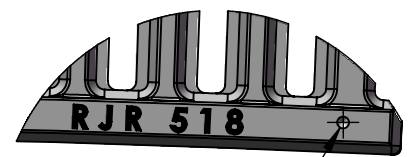

4 Drill Points
in Back

SIDE VIEW
scale 1:4

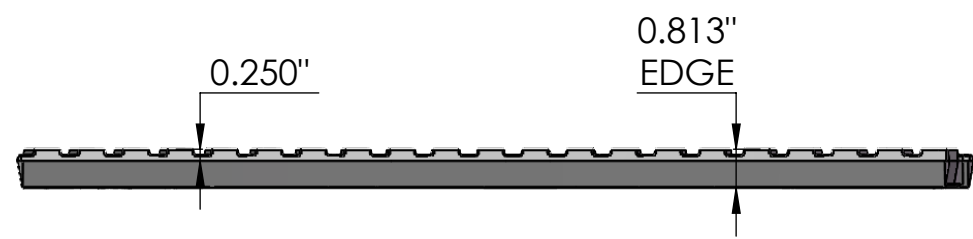

R18'-2.781"
CLR



ISO-VIEW
scale 1:8

Regular Joe 5" x 20" Trench Grate
18'-3" C.L.R.

NOTES:

1. ADA Compliant: No thru openings greater than 1/2".
2. Ships in pieces: 1
3. Due to casting inconsistencies, all dimensions are nominal.

Made in USA ©2018 Iron Age Designs

<p>IRON AGE DESIGNS Telephone 206.276.0925 www.ironagegrates.com</p>	Material: Ductile Iron 65-45-12	Weight: 9.83 lbs.	Free Drain Area: 23.12 in/sq., or 24.47 %	By: MS Checked: MS Date: 2-21-22
	Finish: Raw	Edge: 0.8125"	Flow Rate: 30.29 GPM, or .067 CuFt./sec.	© Registration: Pending Scale: NTS
	Fits: Iron Age Custom Frames SOLD SEPARATELY	Product ID: RJR5-2019918	Drawing Name: 01_RJoe_I_5x18'3"_TrenchGrate	