

CLR 30'-0"

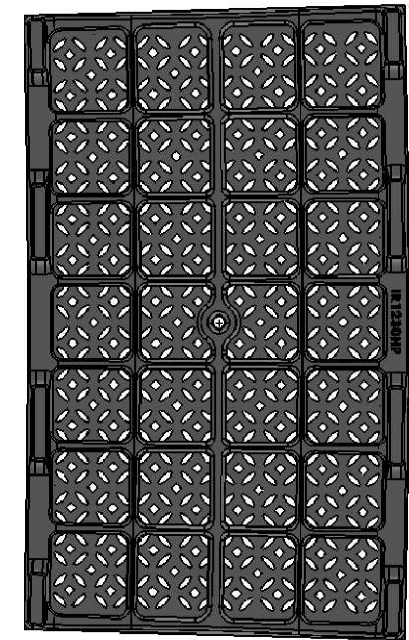
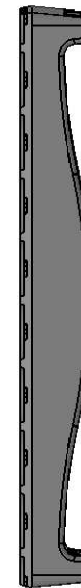

NOTES:

1. Material: cast ductile iron
2. Natural finish
3. Edge thickness: 1 1/2"
4. Fits custom frame by: Iron Age Designs®
5. Heel-Proof; No openings greater than 1/4"
6. Weight approx. 30 lbs
7. Due to casting inconsistencies all dimensions are nominal

 **IRON AGE** 2104 SW 152nd St #4 TEL 206.276.0925
DESIGNS Burién, WA 98166 FAX 206.257.0318
www.ironagedesigns.com

Interlaken 12" Heel-Proof Trench Grate
 30'-0" C.L.R.

Drawn by: JH

Date: 1/7/14

Scale: NTS

DWG. NO. 001-INT.I.12x30rad

© 2014 Iron Age Designs