

TOP VIEW
scale 1:6

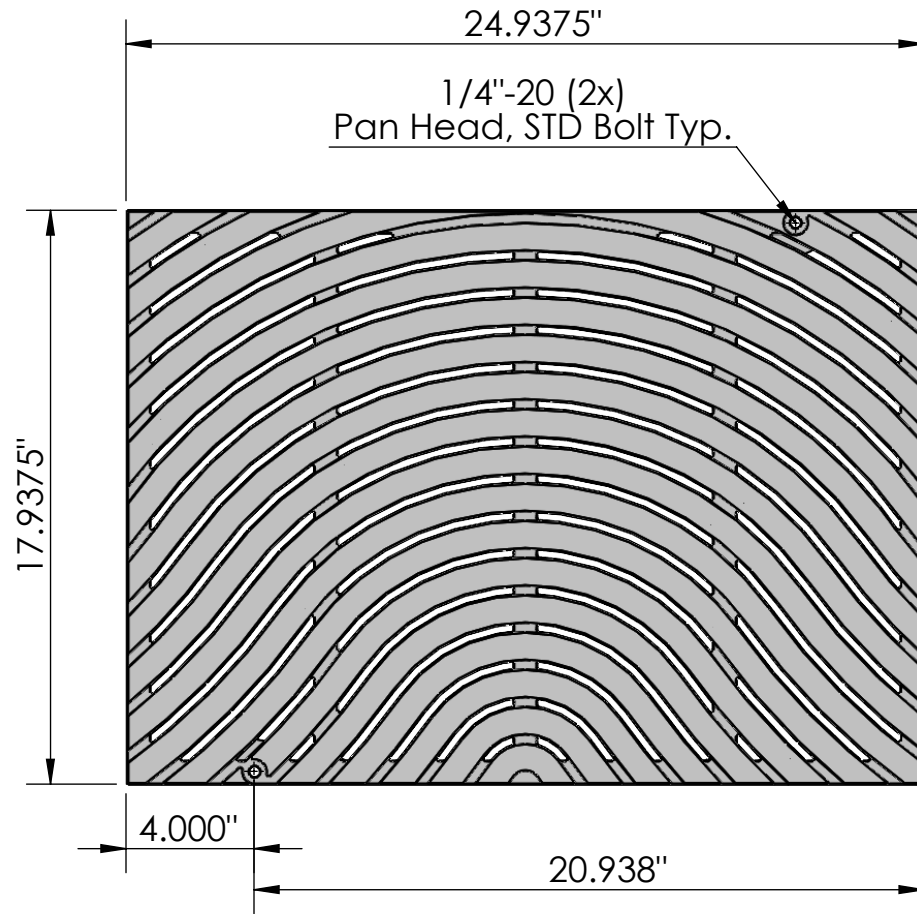

EDGE VIEW
scale 1:6

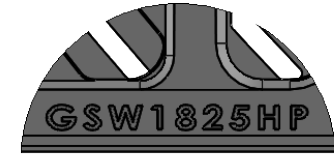
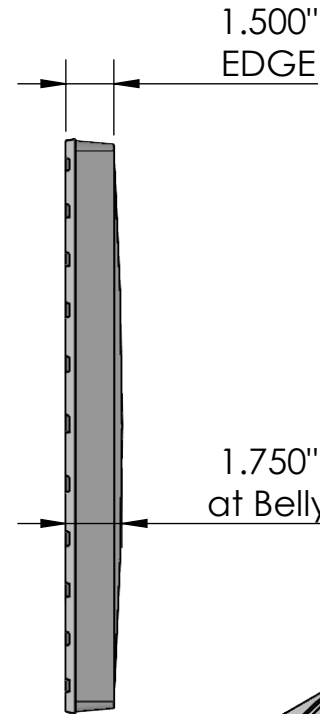

CASTING-ID
scale 1:2

ISO-VIEW
scale 1:8

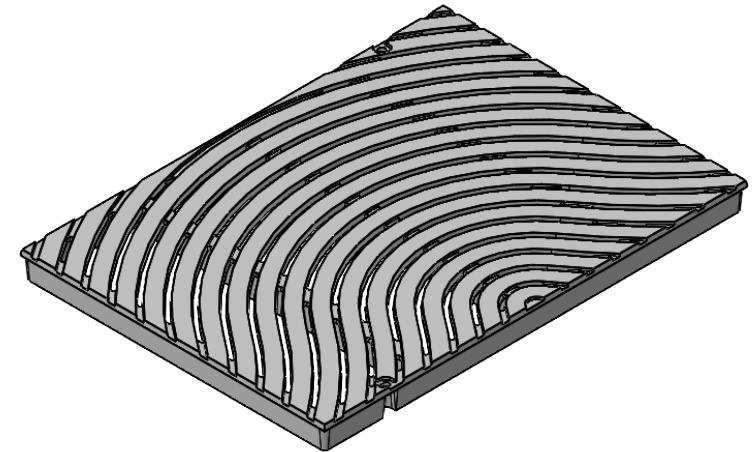

SIDE VIEW
scale 1:6



NOTES:

1. Heelproof: No thru openings greater than 1/4".
2. Ships in pieces: 1
3. Due to casting inconsistencies, all dimensions are nominal.

Made in USA ©2021 Iron Age Designs

Ground Swell 18"x 25" Catch Basin Grate - Heel Proof -Heavy Duty

| | | | | |
|---|--|---|--|---|
| <p>IRON AGE DESIGNS Telephone 206.276.0925 www.ironagegrates.com</p> | <p>Material: Ductile Iron 65-45-12</p> | <p>Weight: 55.98 lbs.</p> | <p>Free Drain Area: 66.87 in/sq., or 14.94 %</p> | <p>By: MS Checked: MS Date: 4-5-24</p> |
| | <p>Finish: Raw</p> | <p>Edge: 1.500"</p> | <p>Flow Rate: 87.60 GPM, or .195 CuFt./sec.</p> | <p>© Registration: Pending Scale: NTS</p> |
| | <p>Fits: Iron Age Custom Frames SOLD SEPARATELY</p> | <p>Product ID: GSX18-25I99HPHD</p> | <p>Drawing Name: 03_GSW_I_18x25_HPHD_CatchBasinGrate_Iron</p> | |