

TOP VIEW

scale 1:14

**CASTING-ID**

scale 1:2

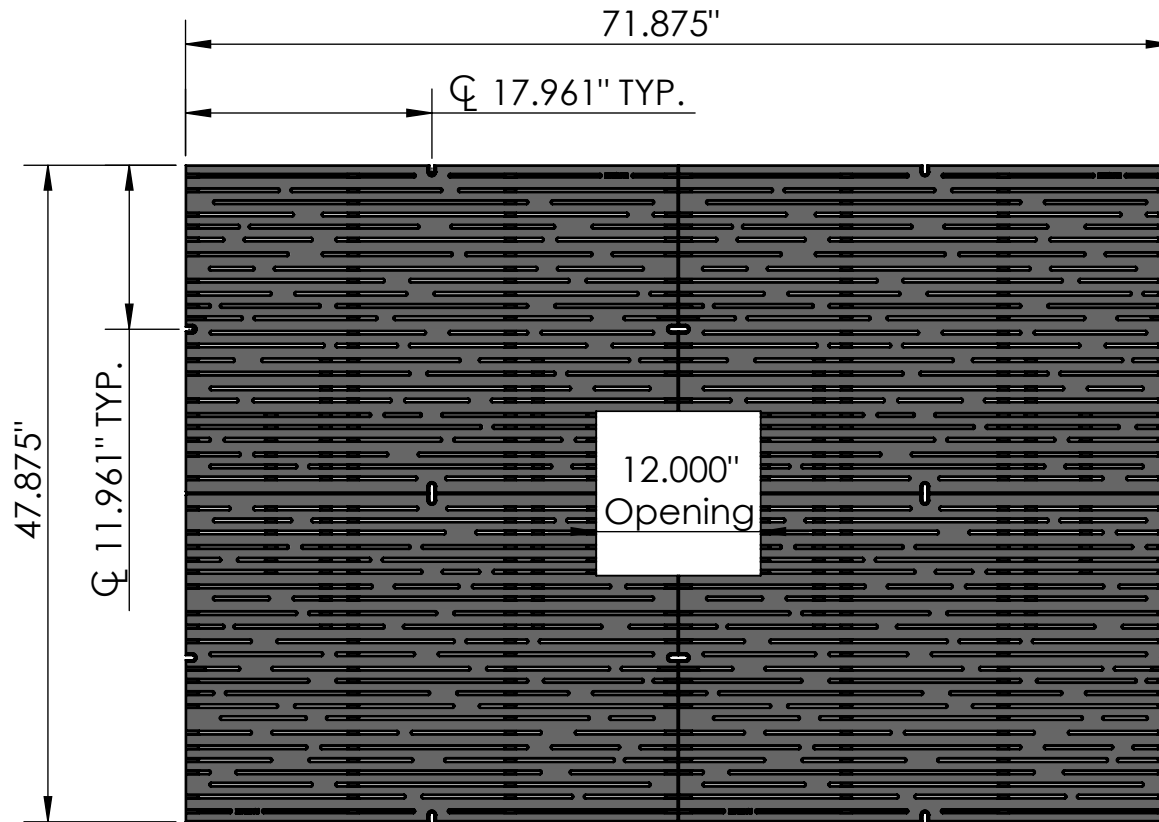
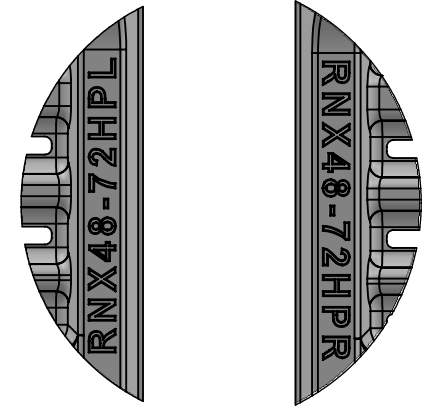

1/4"-20 (16x)
Pan Head
STD-Bolt

ISO-VIEW

scale 1:22

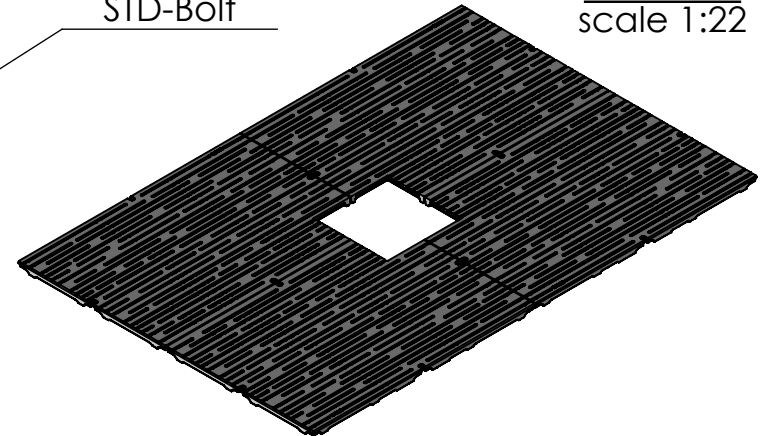
**SIDE VIEW**

scale 1:14

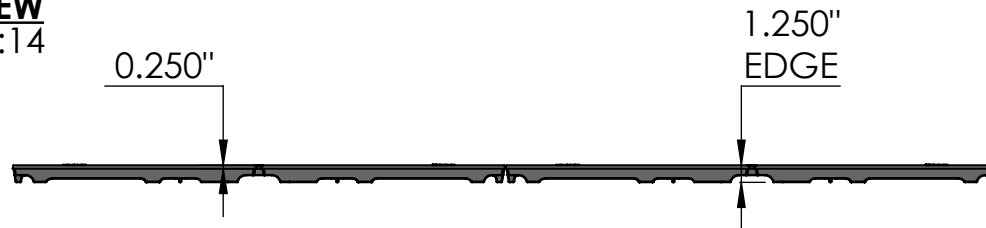
**NOTES:**

1. Heelproof: No thru openings greater than 1/4".
2. Pieces per Set: 4
3. Due to casting inconsistencies, all dimensions are nominal.
4. Center Opening Options:
Cast at 12", 24" or Breakouts at 16", 20".
5. Pedestrian Load Only.

Made in USA

©2020 Iron Age Designs

Rain 4' x 6' Tree Grate Heel Proof

IRON AGE
DESIGNS

Telephone 206.276.0925
www.ironagegrates.com

Material: Ductile Iron 65-45-12 or better**Finish:** Raw

Fits: Iron Age Custom Frame
SOLD SEPARATELY

Weight: 306.84 lbs.**Edge:** 1.250"

Product ID:
RNK48-72199TGHP

Free Drain Area: 451.94 in/sq. or 13.72 %**Flow Rate:** 592.05 GPM**Drawing Name:** 01_RAI_I_48x72HP_TreeGrate_Comp_12open**By:** MS **Checked:** MS**© Registration:** Pending**Date:** 2-18-21**Scale:** NTS

TOP VIEW

scale 1:8

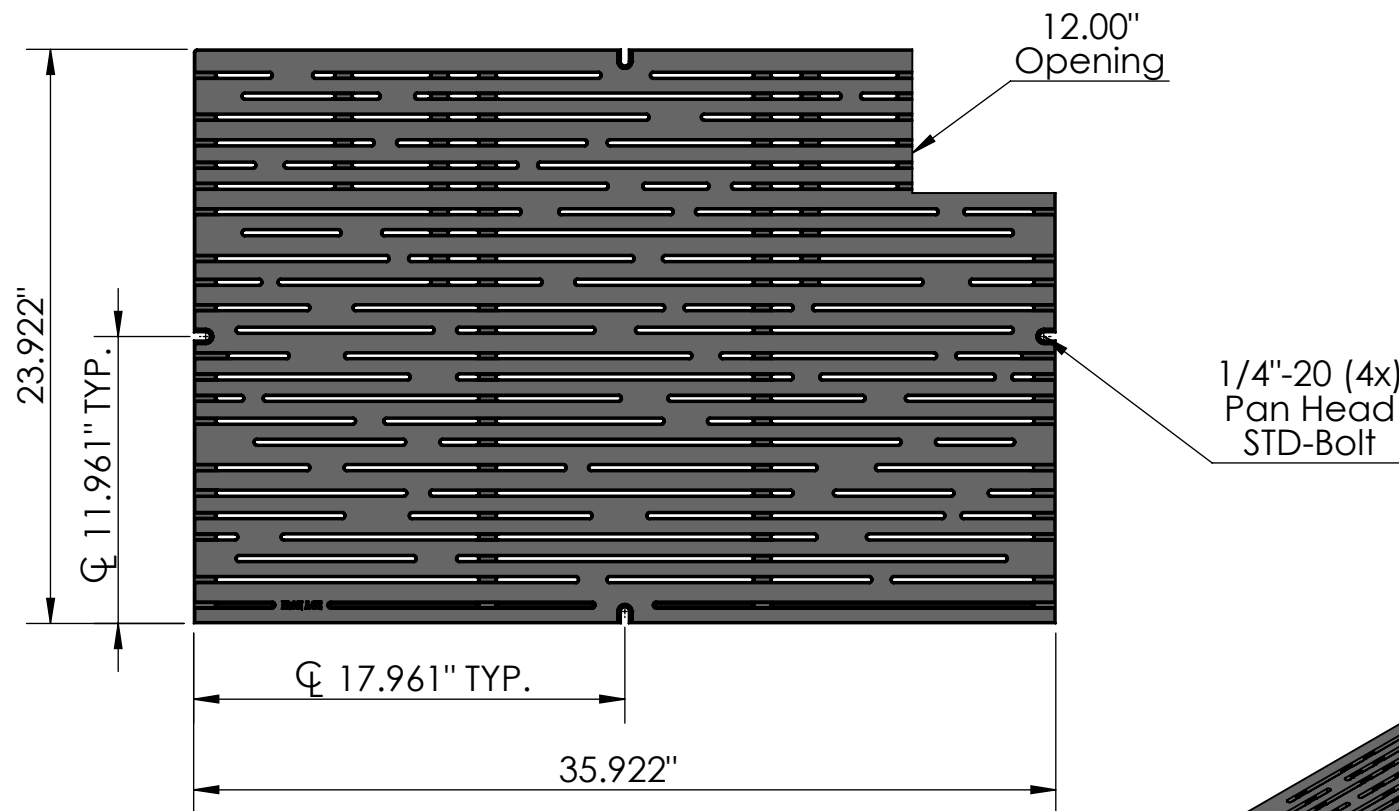
**CASTING-ID**

scale 1:2

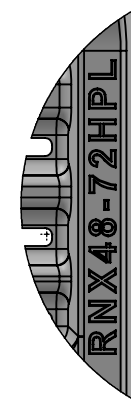
**ISO-VIEW**

scale 1:12

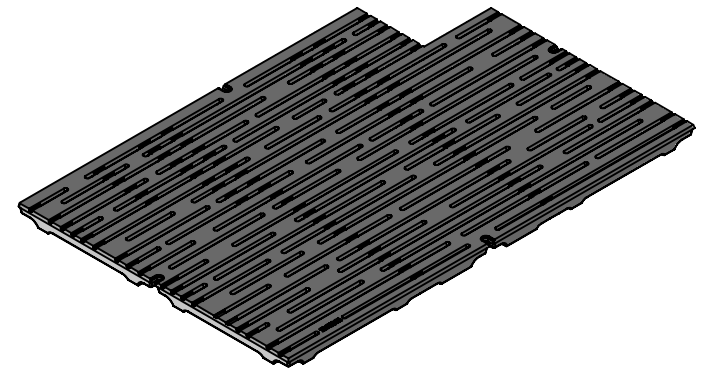
**SIDE VIEW**

scale 1:8

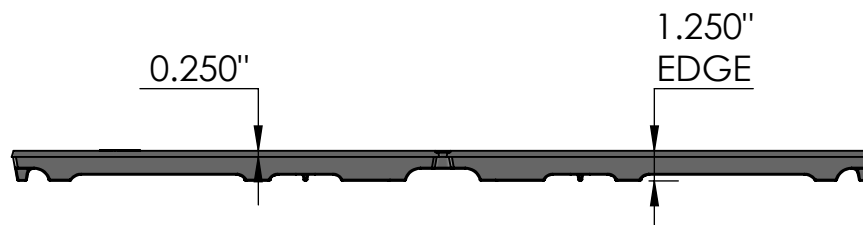
**Rain 4' x 6' Tree Grate Heel Proof - Left Panel****NOTES:**

1. Heelprof: No thru openings greater than 1/4".
2. Due to casting inconsistencies, all dimensions are nominal.
3. Pedestrian Load Only.

Made in USA

©2020 Iron Age Designs

**IRON AGE
DESIGNS**

 Telephone 206.276.0925
 www.ironagegrates.com

Material: Ductile Iron 65-45-12 or better	Weight: 76.72 lbs.	Free Drain Area: 112.87 in/sq. or 13.70 %	By: MS	Checked: MS	Date: 2-18-21
Finish: Raw	Edge: 1.250"	Flow Rate: 147.86 GPM	© Registration: Pending		Scale: NTS
Fits: Iron Age Custom Frame SOLD SEPARATELY	Product ID: RN48-72I99TGHP	Drawing Name: 01_RAI_I_48x72HP_TreeGrate_12open			

Page 2

TOP VIEW

scale 1:8

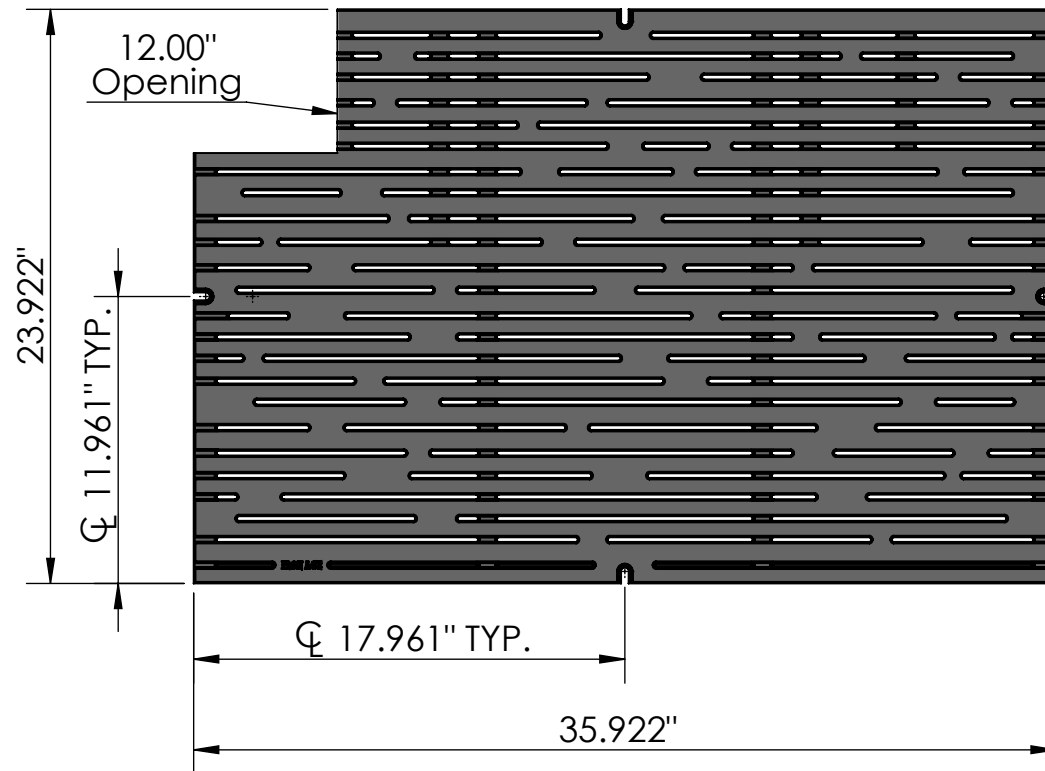
**CASTING-ID**

scale 1:2

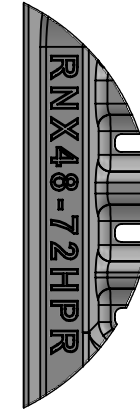

1/4"-20 (4x)
Pan Head
STD-Bolt

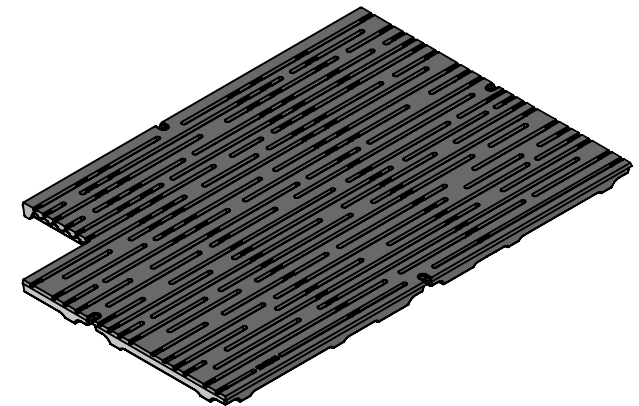
ISO-VIEW
scale 1:12**SIDE VIEW**

scale 1:8

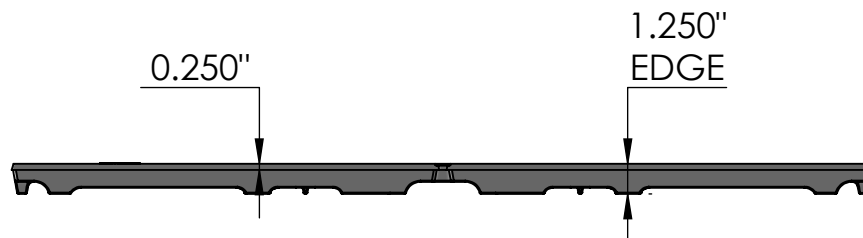
**NOTES:**

1. Heelprof: No thru openings greater than 1/4".
2. Due to casting inconsistencies, all dimensions are nominal.
3. Pedestrian Load Only.

Made in USA

©2020 Iron Age Designs

Rain 4' x 6' Tree Grate Heel Proof - Right Panel
**IRON AGE
DESIGNS**

Telephone 206.276.0925
www.ironagegrates.com

Material: Ductile Iron 65-45-12 or better	Weight: 76.70 lbs.	Free Drain Area: 113.10 in/sq. or 13.73 %	By: MS	Checked: MS	Date: 2-18-21
Finish: Raw	Edge: 1.250"	Flow Rate: 148.16 GPM	© Registration: Pending		Scale: NTS
Fits: Iron Age Custom Frame SOLD SEPARATELY	Product ID: RNX48-72I99TGHP	Drawing Name: 01_RAI_I_48x72HP_TreeGrate_12open			

Page 3