

Top  
Scale 1:6

26.625"

26.50"

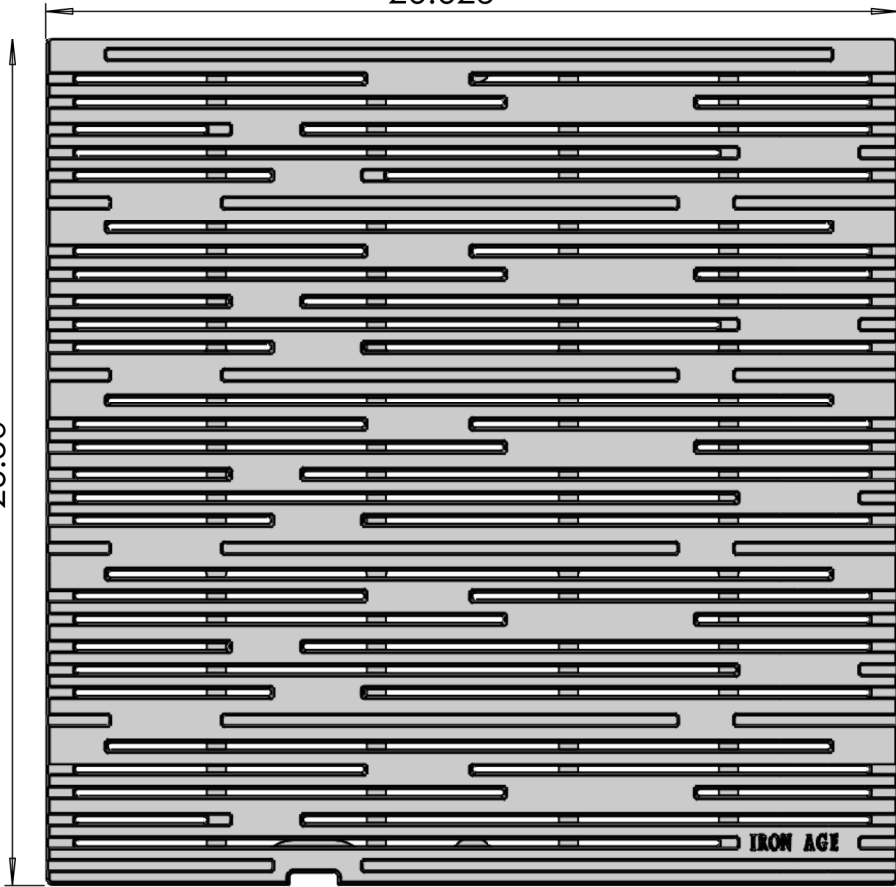

2.50"

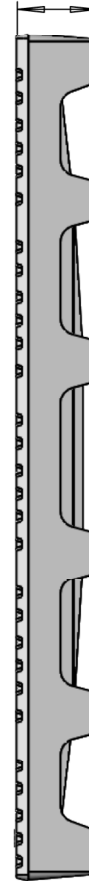

Edge  
Scale 1:6

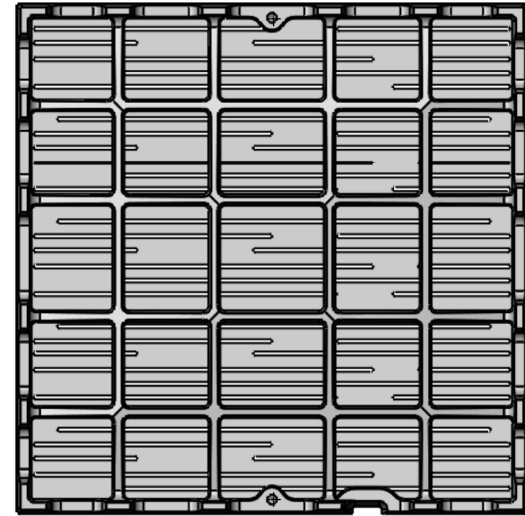

Bottom  
Scale 1:10

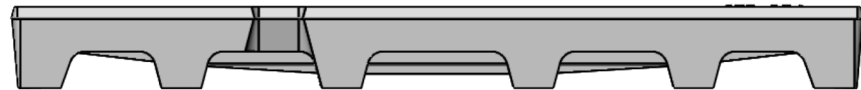

Side  
Scale 1:6

Perspective  
Scale 1:10

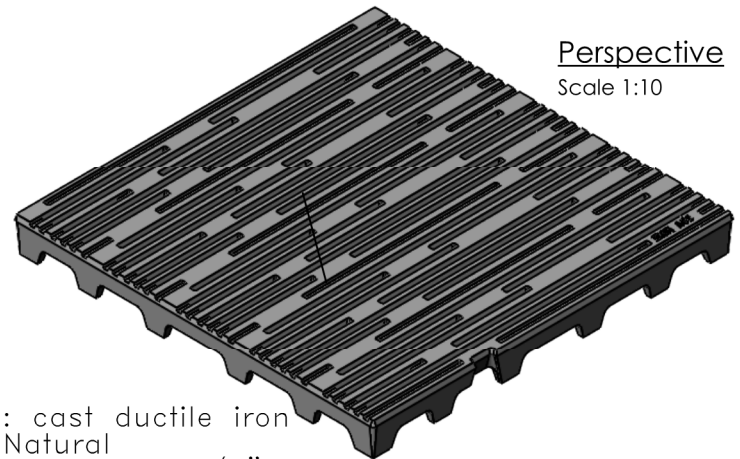

NOTES:

1. Material: cast ductile iron
2. Finish: Natural
3. Edge thickness: 2 1/2"
4. Fits frame by: Iron Age
5. Heelproof; No openings greater than 1/4"
6. Weight approx. 110 lbs
7. Due to casting inconsistencies all dimensions are nominal

 **IRON AGE** 2104 SW 152nd St #4 TEL 206.276.0925  
**DESIGNS** Burien, WA 98166 FAX 206.257.0318  
 www.ironagedesigns.com

Rain 26"x27" Heel-Proof, Heavy-Duty  
Catch Basin Grate

Drawn by: JH  
Date: 7/17/17  
Scale: Not to Scale

DWG. NO. 01-RAI.I.27x26\_HD\_Custom

© 2017 Iron Age Designs

Registration Number:  
VA 2-112-793