

TOP VIEW
scale 1:4

11.893" Sq.

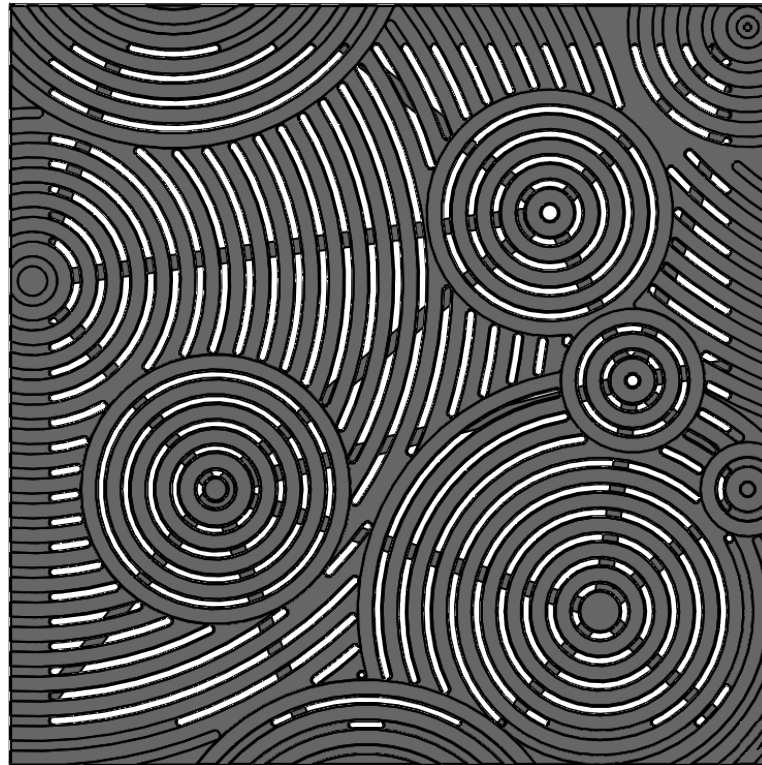

CASTING-ID
scale 1:3

1/4-20 Drill Point (x4)

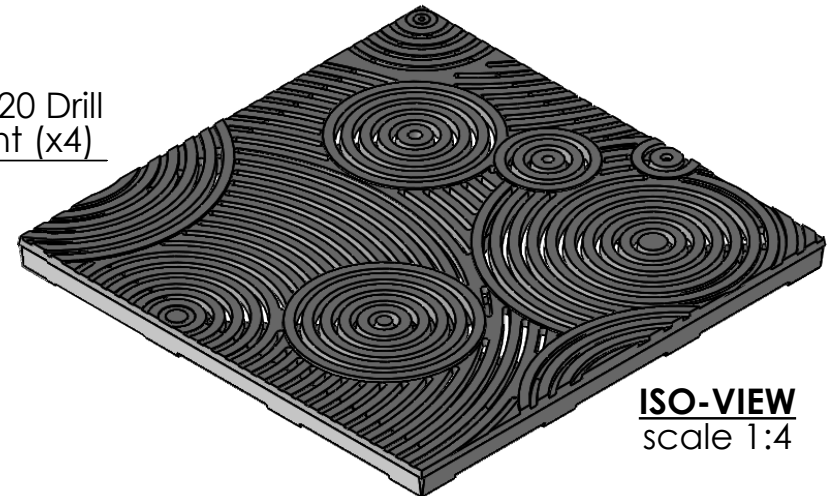
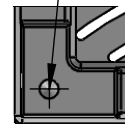

ISO-VIEW
scale 1:4

SIDE VIEW
scale 1:4

0.258"
0.81" EDGE

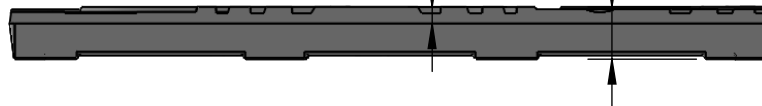

NOTES:

1. Heelproof: No thru openings greater than 1/4".
2. Ships in pieces: 1
3. Due to casting inconsistencies, all dimensions are nominal.

Made in USA ©2008 Iron Age Designs

Oblio 12"x 12" Catch Basin - 'Tight' - Heel Proof

 IRON AGE DESIGNS Telephone 206.276.0925 www.ironagegrates.com	Material: Cast Ductile 65-45-12	Weight: 10.52lbs.	Free Drain Area: 25.00 in/sq., or 17.92 %	By: RJ Checked: MS Date: 5-18-23
	Finish: Raw	Edge: 0.81"	Flow Rate: 32.75 GPM, or .073 CuFt./sec.	© Registration: Pending Scale: NTS
	Fits: Iron Age Custom Frames SOLD SEPARATELY	Product ID: OX12-12199HP	Drawing Name: 02_OBL_C_12x12HP-Tight_CatchBasin_Iron	