

**TOP VIEW**  
scale 1:3

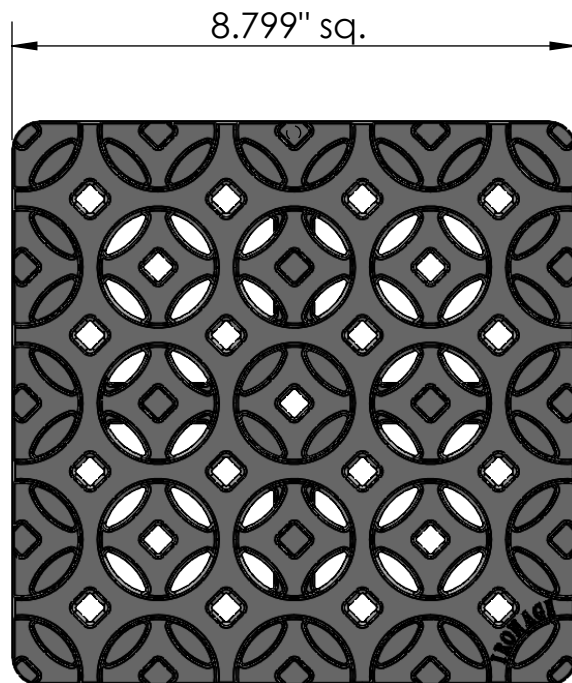

Drill Point (2x)  
on Back

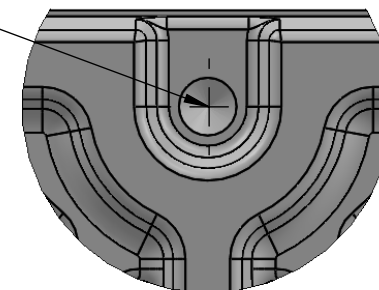

**CASTING-ID**  
scale 1:1



**SIDE VIEW**  
scale 1:3

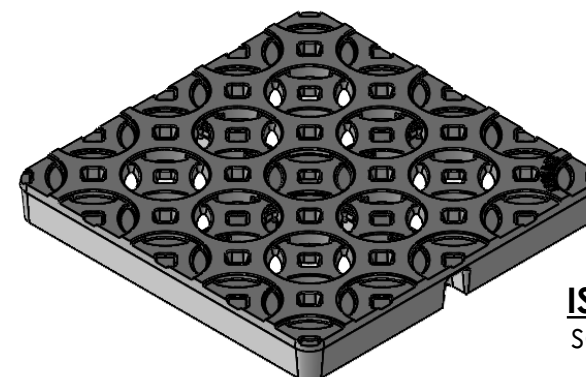
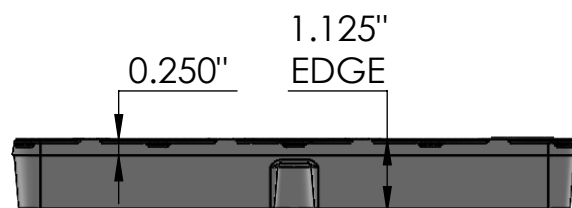

**ISO-VIEW**  
scale 1:8

**NOTES:**

1. ADA Compliant: No thru openings greater than 1/2".
2. Ships in pieces: 1
3. Due to casting inconsistencies, all dimensions are nominal.

Made in USA ©2010 Iron Age Designs

**Interlaken 9" x 9" Catch Basin Grate**

 <b>IRON AGE</b> <b>DESIGNS</b> Telephone 206.276.0925 www.ironagegrates.com	<b>Material:</b> Ductile Iron 65-45-12	<b>Weight:</b> 10.50 lbs.	<b>Free Drain Area:</b> 7.56 in/sq., or 9.76 %	<b>By:</b> MS	<b>Checked:</b> MS	<b>Date:</b> 5-14-25
	<b>Finish:</b> Raw	<b>Edge:</b> 1.125"	<b>Flow Rate:</b> 9.90 GPM, or .022 CuFt./sec.	<b>© Registration:</b> VA 2-007-113		
	<b>Fits:</b> NDS 900 Series SOLS SEPARATELY	<b>Product ID:</b> IN9-9111	<b>Drawing Name:</b> 01_LOC_N_9x9_CatchBasin_Iron			