

**Array 3x**



**Top**

17.875"

2.90"

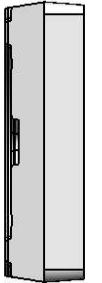
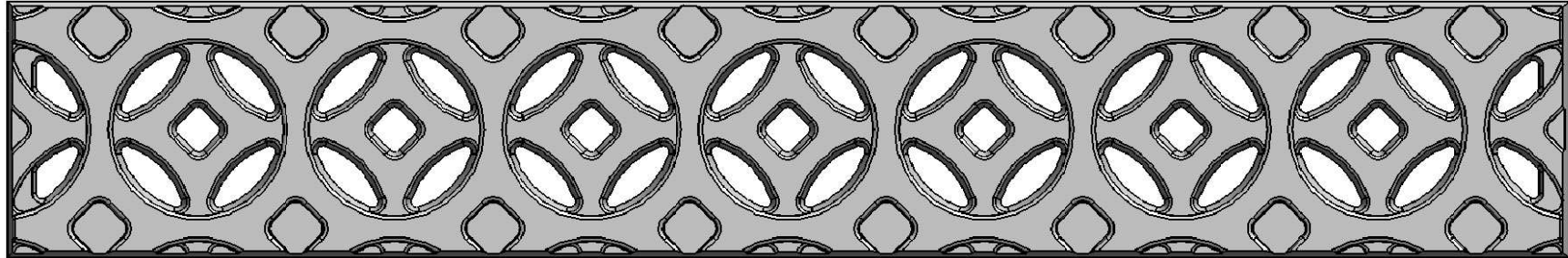

**Edge**

**Side**

.8125" At bearing edge

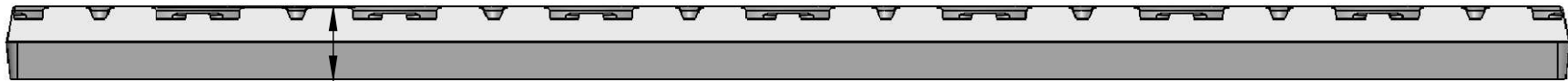

**Perspective**

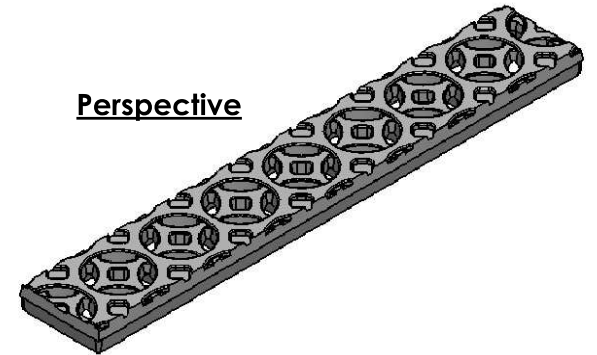

**NOTES:**

1. Material: cast iron
2. Finish: Natural
3. Edge thickness: 13/16"
4. Fits frame by: ACO™ MiniKlassik
5. No openings greater than 1/2"
6. Weight approx. <6 lbs
7. Due to casting inconsistencies all dimensions are nominal

 **IRON AGE** 2104 SW 152nd St #4 TEL 206.276.0925  
**DESIGNS** Burien, WA 98166 FAX 206.257.0318  
www.ironagedrains.com

**Interlaken 3"x18" Trench Drain**

JOB NO. \_\_\_\_\_ Drawn by: JH  
DWG. NO. 02-INT.1.3x18 Date: 3/2/15  
Scale: Not to Scale