

TOP VIEW
scale 1:5

23.875" Sq.

11.938"
(x4)
To center of bolt down

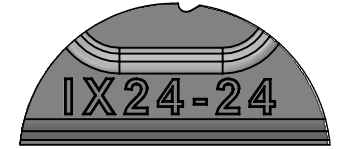
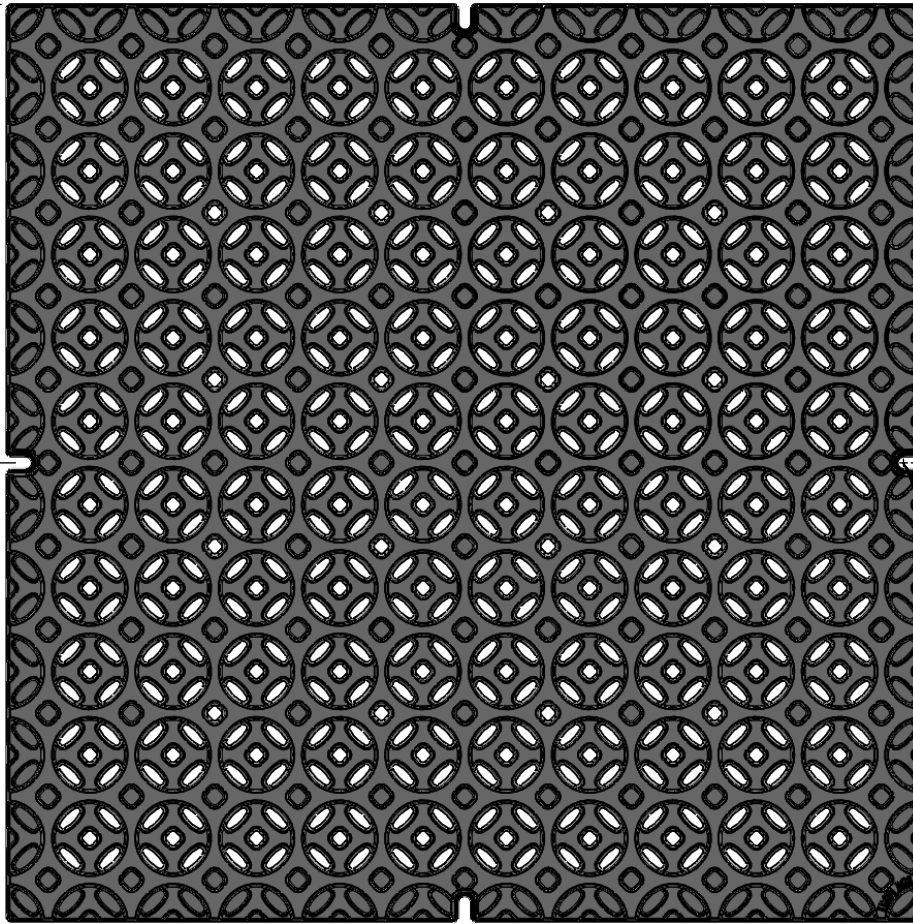

CASTING-ID
scale 1:2

1/4"-20 Pan
Head STD
Bolt (x4)

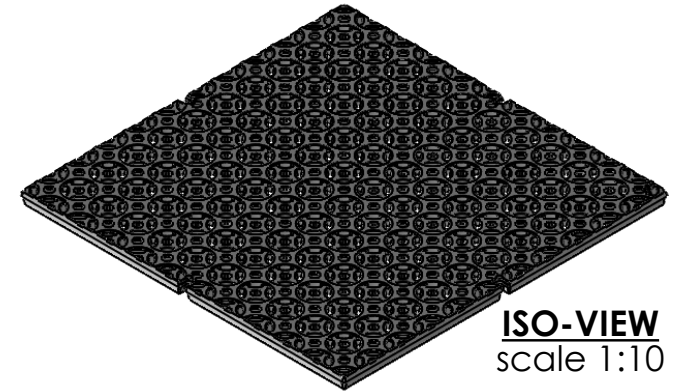

ISO-VIEW
scale 1:10

SIDE VIEW
scale 1:5

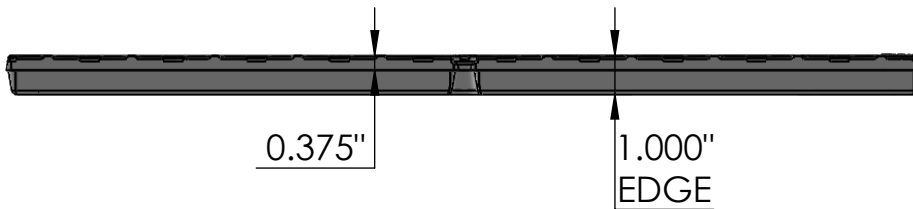

NOTES:

1. ADA Compliant: No thru openings greater than 1/2".
2. Ships in pieces: 1
3. Due to casting inconsistencies, all dimensions are nominal.
4. Pedestrian Load Only

Made in USA

©2013 Iron Age Designs

Interlaken 24"x 24" Catch Basin Grate

IRON AGE
DESIGNS
Telephone 206.276.0925
www.ironagegrates.com

Material: Ductile Iron 65-45-12	Weight: 64.67 lbs.	Free Drain Area: 67.16 in/sq., or 11.78 %	By: RJ	Checked: MS	Date: 9-28-23
Finish: Raw	Edge: 1.000"	Flow Rate: 87.97 GPM, or .195 CuFt./sec.	© Registration: Pending	Scale: NTS	
Fits: Iron Age Custom Frames SOLD SEPARATELY	Product ID: IX24-24I99FW	Drawing Name: 03_INT_I_24sq_CatchBasin			