

**UNIVERSAL CORNER POST - mounting options:**

- 1) tapered base fits snugly into standard 1" pipe (recommend: bed in silicone) optional set screw
- 2) feet available; for spike or bolt down
- 3) hole can accommodate #3 rebar to directly cast in concrete

**UNIVERSAL POST:**  
- same mounting ops, connectors & posts are interchangeable

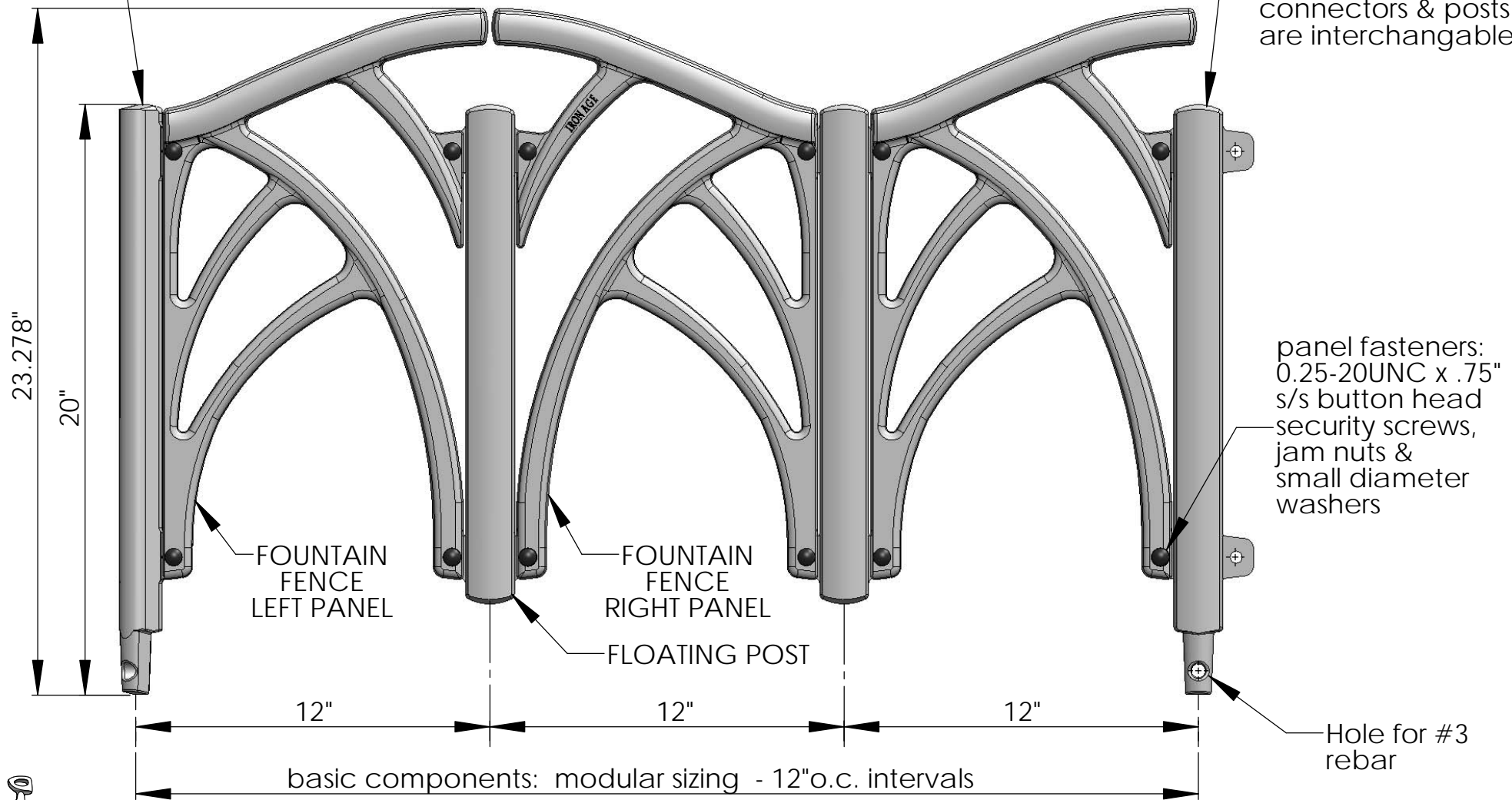

panel fasteners:  
0.25-20UNC x .75"  
s/s button head  
security screws,  
jam nuts &  
small diameter  
washers

Hole for #3  
rebar

basic components: modular sizing - 12"o.c. intervals

**IRON AGE** 2104 SW 152nd st #4 TEL 206.276.0925  
DESIGNS Burien, WA 98166 FAX 206.257.0318  
www.ironagedesigns.com

**Fountain Planting Fence System**

DWG. NO. FTN.P-Fence  
SHEET NO. 0-BASIC COMPONENTS

Drawn by: CD  
Date: 06/21/11  
Scale: NTS

**NOTES:**

1. Material: cast ductile iron
2. Finish: Natural or powder coat paint
3. Due to casting inconsistencies all dimensions are nominal

© 2011 Iron Age Designs

TOP scale 1:10



TOP scale 1:10

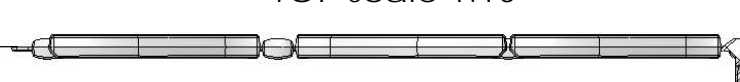

FRONT scale 1:10

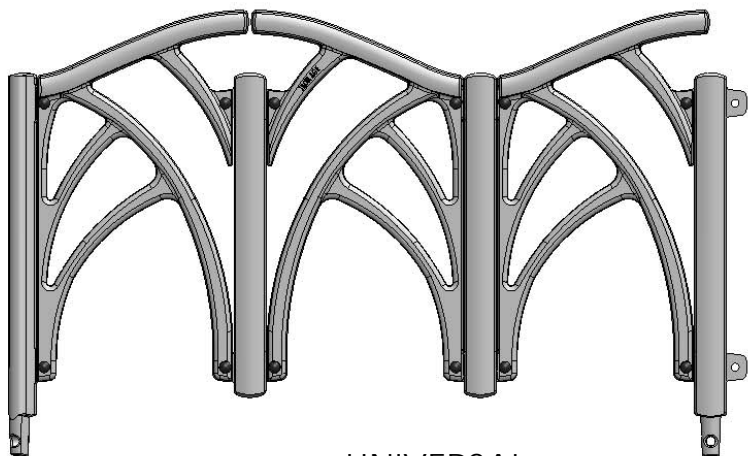

R Side scale 1:10

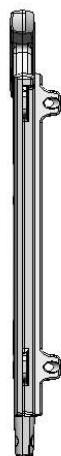

REAR scale 1:10

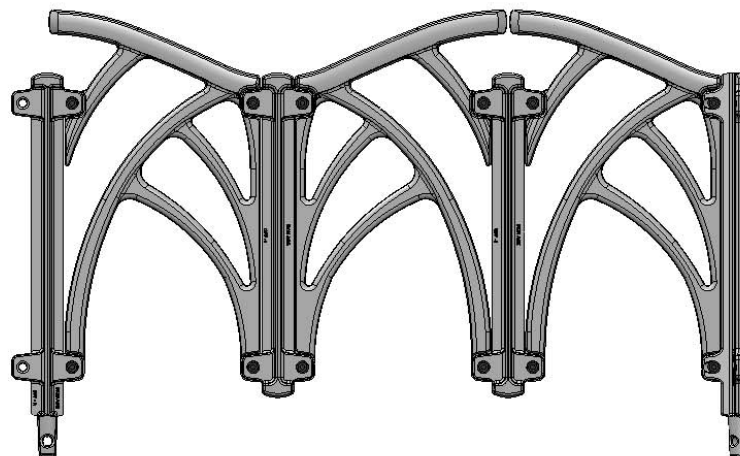

FRONT EXPLODED scale 1:10

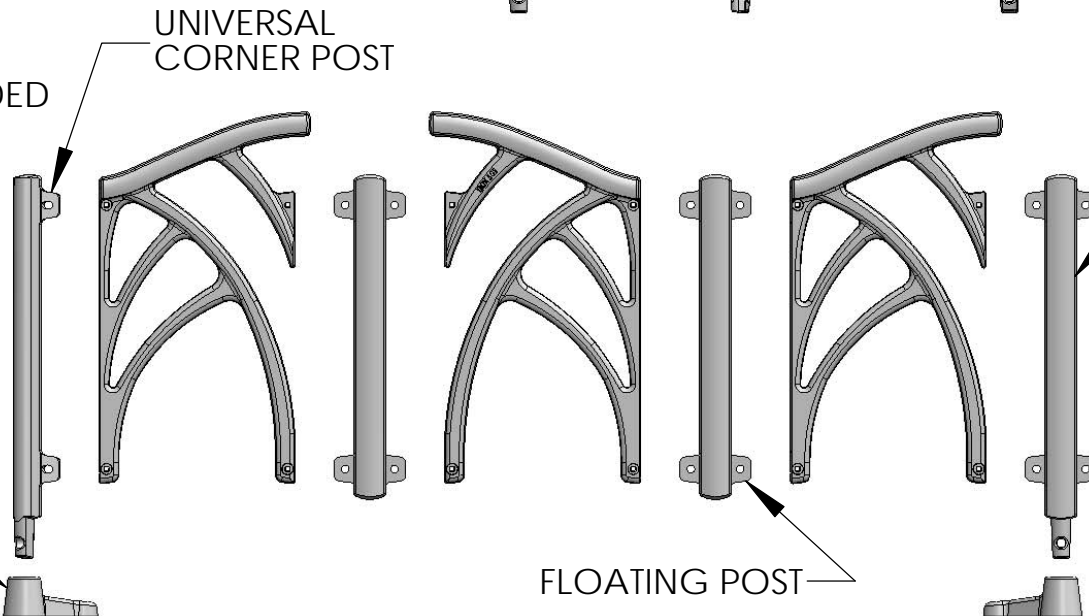

UNIVERSAL CORNER POST

UNIVERSAL POST recommend: span no more than 3' between full height posts or corner posts

FOOT

FLOATING POST

ISOMETRIC scale 1:15

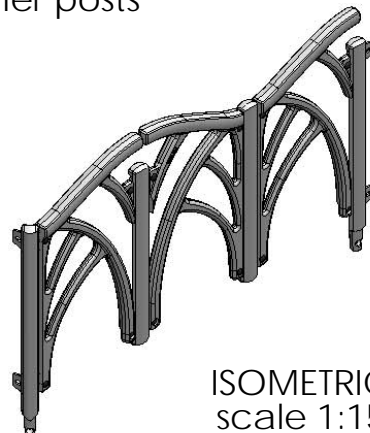

**IRON AGE** 2104 SW 152nd st #4 TEL 206.276.0925  
DESIGNS Burién, WA 98166 FAX 206.257.0318  
www.ironagedesigns.com

NOTES:

1. Material: cast ductile iron
2. Finish: Natural or powder coat paint
3. Due to casting inconsistencies all dimensions are nominal

Fountain Planting Fence System

DWG. NO. FTN.P-Fence  
SHEET NO. 1-VIEWS

Drawn by: CD  
Date: 06/21/11  
Scale: NTS

© 2011 Iron Age Designs

FOUNTAIN 2'x2'  
PLANTING FENCE  
scale 1:10

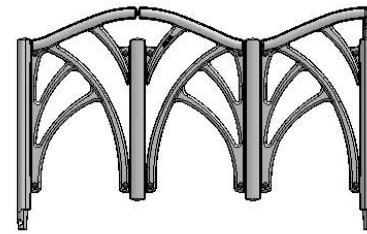
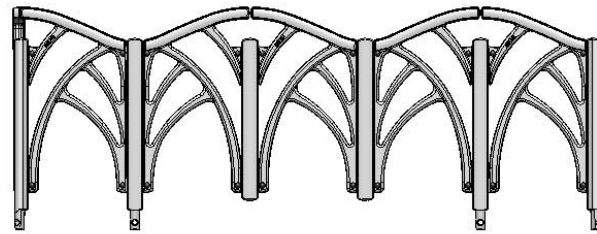
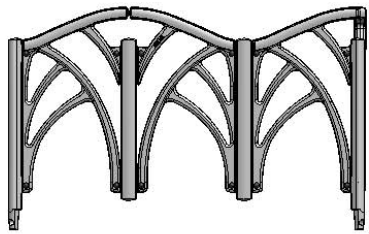
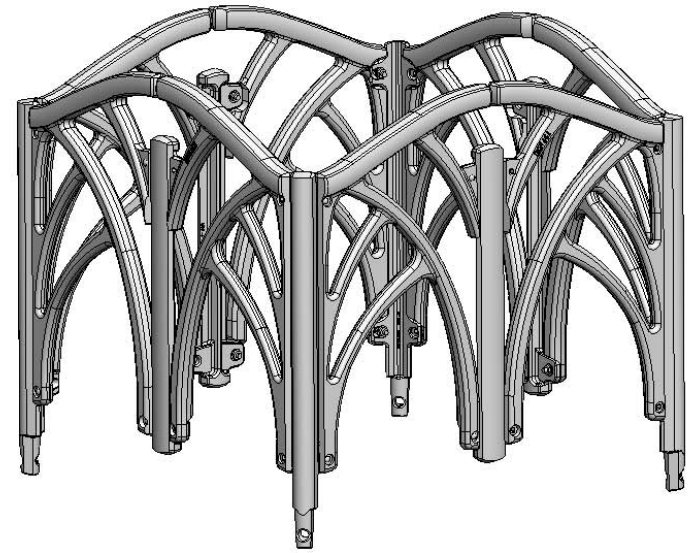
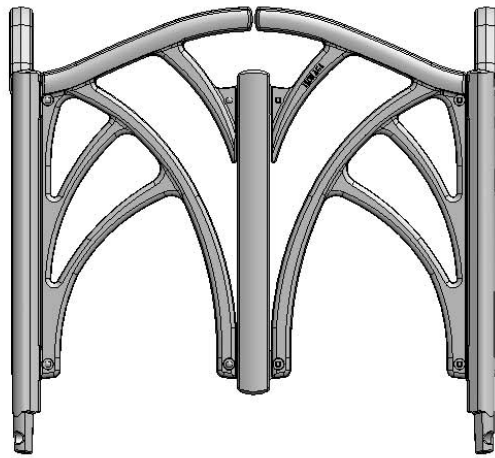

FOUNTAIN 3'x5' PLANTING FENCE scale 1:20

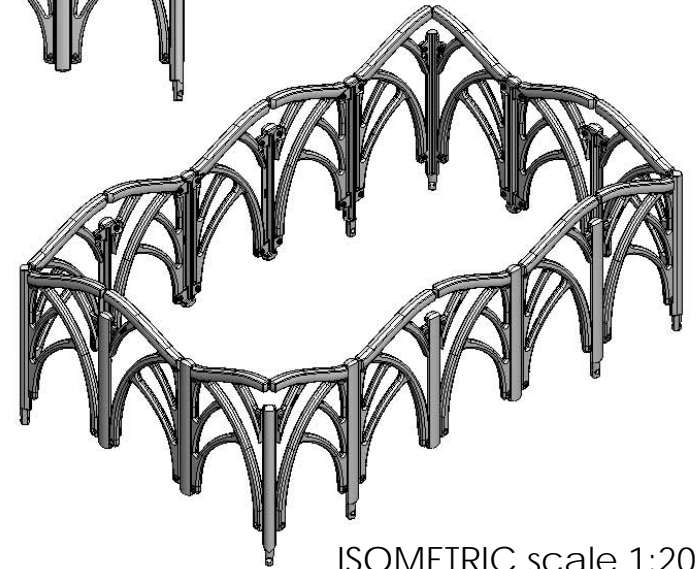

ISOMETRIC scale 1:20



**IRON AGE** 2104 SW 152nd st #4 TEL 206.276.0925  
DESIGNS Burién, WA 98166 FAX 206.257.0318  
www.ironagedesigns.com

Fountain Planting Fence System

DWG. NO. FTN.P-Fence  
SHEET NO. 2 - SIZE/INTERVAL

Drawn by: CD  
Date: 06/21/11  
Scale: NTS

NOTES:

1. Material: cast ductile iron
2. Finish: Natural or powder coat paint
3. Due to casting inconsistencies all dimensions are nominal

© 2011 Iron Age Designs

TOP  
VIEWS

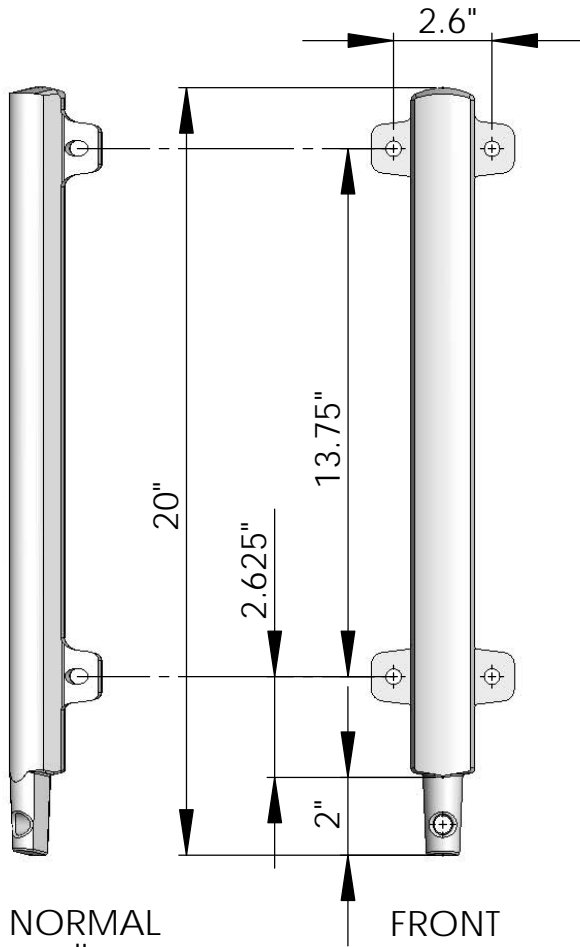
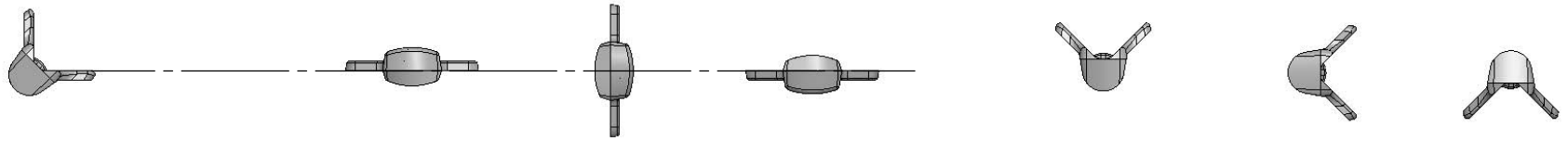

shown NORMAL  
to fence line

CORNER POST

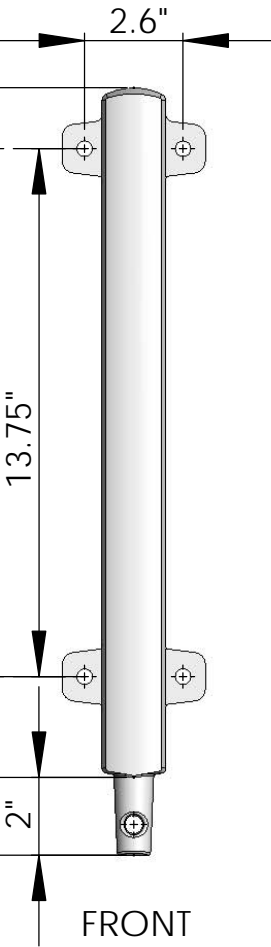

shown NORMAL to fence & Parting Lines

UNIVERSAL POST

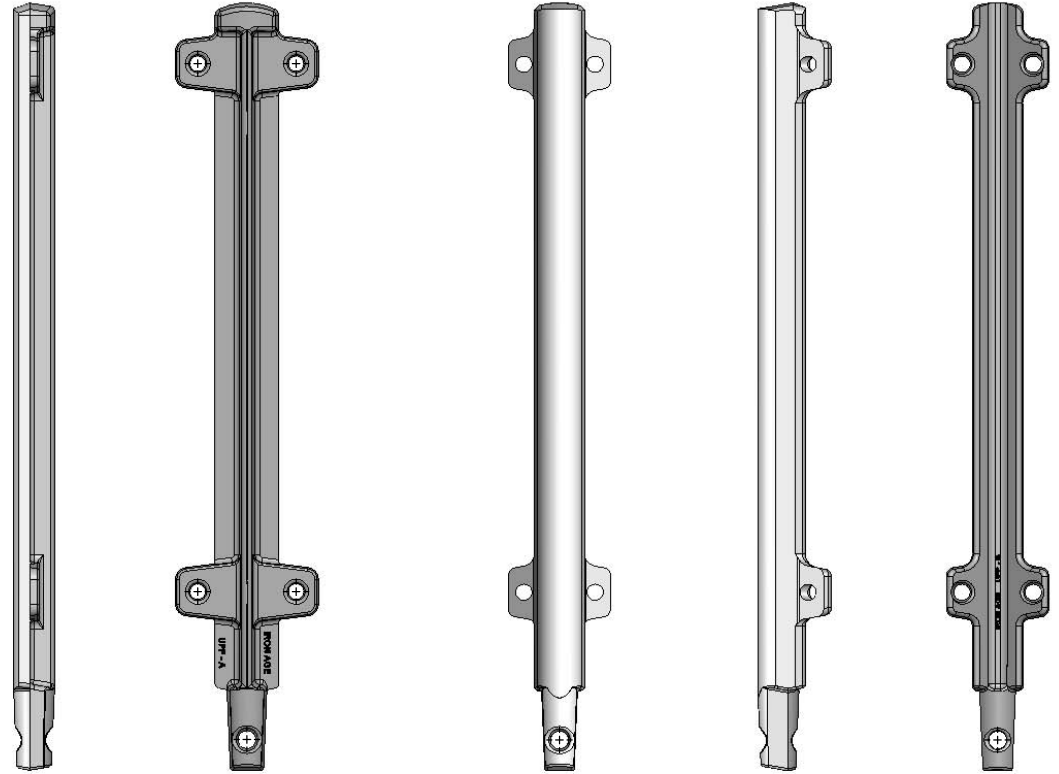

shown NORMAL to Parting Line

CORNER POST



**IRON AGE** 2104 SW 152nd st #4 TEL 206.276.0925  
 DESIGNS Burien, WA 98166 FAX 206.257.0318  
 www.ironagedesigns.com

Fountain Planting Fence System

DWG. NO. FTN.P-Fence  
 SHEET NO. 3 - POSTS

Drawn by: CD  
 Date: 06/21/11  
 Scale: 1:5

NOTES:

1. Material: cast ductile iron
2. Finish: Natural or powder coat paint
3. Due to casting inconsistencies all dimensions are nominal

© 2011 Iron Age Designs